

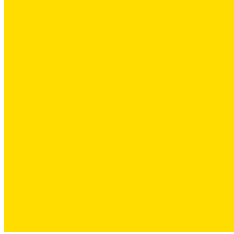

TOGETHER WE BUILD  
INNOVATIVE SOLUTIONS



**PRODUCT  
CATALOGUE**  
FOR CONSTRUCTION  
PROFESSIONALS  
**2021**



WE BUILD INNOVATIVE  
SOLUTIONS TOGETHER

---



**QUILOSA - SELENA IBERIA S.L.U**  
www.quilosa.com  
info.quilosa@selena.com  
Tel.: +34 902 02 18 02

**CENTRAL OFFICES**  
C/ Marie Curie 19, Planta 6.1  
28521 Rivas, Madrid, España  
Tel.: +34 91 627 84 00

**FACTORY**  
Polígono Industrial Quer  
C/ Vega del Henares, 3  
19209 Quer, Guadalajara, España  
Tel.: +34 672 336 555

PRODUCT CATALOGUE  
FOR CONSTRUCTION  
PROFESSIONALS 2021 EDITION

---



## WE BUILD INNOVATIVE SOLUTIONS TOGETHER

Quilosa was founded in Spain in 1940, and we have spent the last 75 years developing tailored, cutting-edge systems that service all of our clients' needs, always meeting the highest standards.

Our main line of business is the development and manufacturing of innovative sealants, polyurethane adhesive foams, and waterproofing products, and their commercialization through the Construction, Industry, and DIY channels.

The remarkable life-span of our company has empowered us into becoming leaders in the 'Chemical Products for Professionals' sector.

Thanks to you, Quilosa keeps growing and reaching new heights every day.

### OUR CORPORATE VIDEO



[www.quilosa.com](http://www.quilosa.com)



## WE ARE ALL OF THIS AND MUCH MORE...

- **INNOVATION AND DEVELOPMENT**  
We have an in-house R&D division equipped with significant experience and relevant market-knowledge. They work tirelessly to improve the performance and to add new benefits to our products. Our systems are tailored to the needs of our professional customers, and we often collaborate with partners from all steps of the supply-chain in research and development projects.
  - **PRODUCTION CAPACITY**  
Our productive facilities are based in Spain, in the province of Guadalajara. Our factory -which covers 19.000 sqm- locally produces all of our adhesives and sealants, making us the company with the highest production capacity in the Iberian Peninsula. We are currently investing on increasing our already high output, as well as expanding our industrial network abroad, in order to keep up with the rapidly growing demand.
  - **GLOBAL QUALITY**  
Quality is at the heart of Quilosa's identity. Our brand is acknowledged as a high-standards' guarantee in all the markets we have established ourselves in. To keep living up to our customer's high expectations, we continually certify our products' quality through third-party, independent tests and trials.
- 
- **TECHNICAL ADVICE AND TRAINING FOR PROFESSIONALS**  
Thanks to the continuous collaboration between Quilosa's team and all of our partners and customers, we can offer insightful advice and relevant technical support: we will answer your questions.  
We also hold regular workshops, both in our office and in-location, helping our partners' salesforce to understand the product's advantages better.  
Please contact your area's representative if you're interested in holding such an event.
  - **SUSTAINABLE DEVELOPMENT**  
We are firmly committed to environmental sustainability. We make this commitment a part of our product development process, so that our systems encourage sustainable construction and energy efficiency.
  - **CUSTOMER ATTENTION**  
Our team is ready to resolve any of your queries: Tel. : 902 02 18 02 / 91 627 84 00 · Monday to Thursday from 9:00 to 18:00 · Friday from 9:00 to 15:00 GMT +1

Since the year 2009, Quilosa has been part of the Selena Group, a global manufacturer and distributor with a wide range of chemical products for construction professionals. The Group is made up of 30 subsidiary companies that produce polyurethane foams, sealants, adhesives, ETICS components and waterproofing materials.

Founded in 1992, Selena was one of the pioneers in offering modern chemical products for construction on the Polish market. Today, the Selena Group employs over 1,700 people and numbers among the world's three main manufacturers of polyurethane foam. Its effective distribution network covers Europe, Asia and North and South America, reaching 42,000 customers and millions of consumers worldwide. It has research and development laboratories in Poland, Spain, Turkey and China, where Selena continually invests in achieving solutions to improve buildings and to expand its product portfolio.

The global experience acquired in different local markets lets the Selena Group develop rapidly to create solutions adapted to users' needs. The production plants located in Poland, Spain, China, South Korea, Brazil, Turkey, Romania and Kazakhstan respond to the growing demand for Selena products.

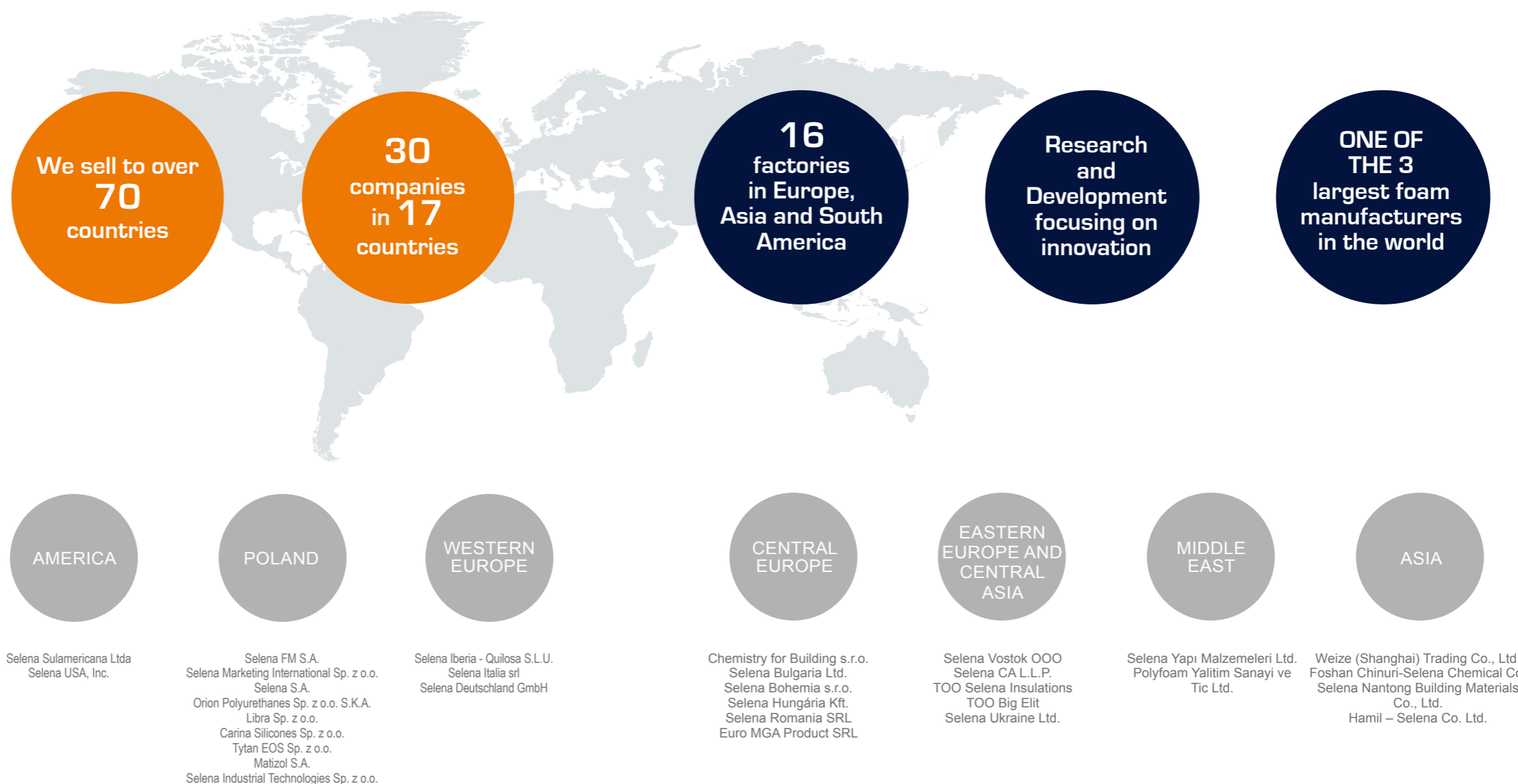

# INDEX

<b>SEALANTS</b>	<b>10</b>	<b>WATERPROOFING SYSTEM</b>	<b>96</b>
Neutral Silicones		Aqua Protect Liquid MS silicone	
Acid Silicones		Aqua Protect Leak Repairer	
Home Use Silicone		Aqua Protect Walkable P4	
MS Polymers		Aqua Protect Acrylic Rubber with microfibers	
Polyurethane Sealants		Aqua Protect Waterproofing Thermal Reducer	
Synthetic Siliconised Sealants		Water Repellents	
Acrylics		Bitumen tape	
Miscellaneous sealants		MS putty for waterproofing	
Accessories		Primer for waterproofing acrylic-based	
Primers		Cool-R System	
Cleaners			
<b>INSTALLATION SYSTEM FOR WINDOWS AND DOORS</b>	<b>46</b>	<b>FLOORING SYSTEM</b>	<b>106</b>
Three Barrier Insulation System		Primers and self-levelling pastes	
Professional Window and Door System		Flooring Adhesives	
		Artificial Turf Installation System	
<b>POLYURETHANE FOAMS</b>	<b>54</b>	<b>GARDEN &amp; POOLS</b>	<b>114</b>
Professional PU Foams		Quilosa Band Union	
Multi-Purpose PU Foams		Quilosa BP-390 Artificial Grass Adhesive	
Accessories		Swimming Pool Sealant	
Guns		Pool's Putty	
		Aquariums and Terrariums	
		Mirror Silicone	
		Marble Silicone	
<b>ADHESIVE FOAMS</b>	<b>64</b>	<b>FIRE STOP</b>	<b>120</b>
<b>ADHESIVES</b>	<b>70</b>	Anti-Fire- Protection	
Adhesive Fixation MS		Protection against High Temperatures	
Assembly Adhesives			
White Glues		<b>DIY AND DECORATION</b>	<b>126</b>
Contact Adhesives		Cracks Fillers and Repairs	
PVC Adhesives		Wallpaper Adhesives	
Instant Adhesives		Tiling	
Special Adhesives		Wall and Repairs	
		Bonding and Repairs	
		Varnishes for Handcrafts	
<b>ADHESIVE TAPES</b>	<b>88</b>	<b>SPRAY PAINTS</b>	<b>138</b>
Double-Sided Tape		Acrylic Paint	
Double-sided tape with fibers		Special Paint	
Self-Welding Tape		Primers	
Repair-All Tape		Marker Paint	
Masking Tape			
Duct Tape			
Packing Tape			
<b>CHEMICAL ANCHORS</b>	<b>92</b>	<b>LUBRICANTS</b>	<b>142</b>

# FAST CONSTRUCTION FOR PROFESSIONALS



**FAST  
& PRO**



Find out more here...

## TECHNOLOGICALLY ADVANCED PRODUCTS



Waterproof  
**P4 WALKABLE**  
Fully walkable and 25 years of protection guaranteed



Polyurethane Foam  
**ULTRA FAST 70**  
The fastest foam for windows and doors



Foam Adhesive  
**FIJACION PLACA**  
Fix, fill and level!



Foam Adhesive  
**FIJACION 60 SEG**  
It gets everything done!



Foam Adhesive  
**SATE / ETICS**  
Instant grip



Mounting adhesive  
**POWER FIX**  
The fastest and most resistant adhesive in the World



100% Neutral Silicone  
**PERFECT BATHROOM**  
Suitable for particularly delicate materials

+ HASTENS APLICATION TIME

+ HIGHEST STANDARDS OF QUALITY

+ IMPROVE YIELD

# SEALANTS



The range of sealants offered by Quilosa is made up of products using different technologies and chemical bases intended for sealing both indoor and outdoor joints in commercial, industrial or residential buildings.

In order to choose the right sealant for each application, several factors should be taken into account: joint movement, resistance to weathering, solar light, temperature, need to paint the joint, and type of material on which it will be applied. Correct preparation of the joint and application of the product is essential to obtain optimal performance and the building's appropriate protection against external agents.

## Neutral Silicones

- 11 Orbasil N-25 Colour Windows and Facades
- 12 Orbasil N-26 Windows and Facades
- 12 Orbasil N-16 Construction and Windows
- 13 Orbasil N-09 General Purpose in Construction
- 13 Orbasil N-26 S Sanitary
- 13 Orbasil N-36 Curtain Walls
- 14 Orbasil Screens
- 14 Orbasil N-32 Mirrors
- 14 Orbasil N-34 Structural Glazing
- 15 Orbasil N-97 Windows and Glazing
- 15 Orbasil N-98 Windows and Facades
- 15 Orbasil N-39
- 16 Orbasil N-28 FIRE STOP
- 16 Orbasil N-65 FIRE STOP High Temperatures

## Acid Silicones

- 17 Orbasil K-95 Glazing
- 17 Orbasil K-91 Glazing
- 17 Orbasil K-86 General Purpose
- 18 Aklesil General Purpose
- 18 Orbasil K-94 Aquariums
- 19 Orbasil K-88 FIRE STOP High Temperatures
- 19 Orbasil Joint Former

## Home Use Silicone

- 21 Silicone Multi-Purpose
- 21 Silicone Bathrooms and Kitchens
- 21 Perfect Bathroom Silicone

## MS Polymers

- 23 MS Instant
- 24 Sintex MS-20 Construction Joints
- 25 Sintex MS-35 Bonding and Sealing
- 26 Sintex MS Transparent
- 24 Sintex MS-33 Mirrors
- 25 Sintex MS-52 Structural Bonding
- 25 Sintex MS-80 Transparent Screens
- 27 MS Fix Adhesive Panels
- 27 FIX Panels Tape
- 27 Primer C-29
- 29 1000 Uses & Superfix MS Bonds Seals All
- 29 1000 Uses & Superfix MS Bonds Seals Invisible

## Polyurethane Sealants

- 30 Sintex PU-40 PRO
- 30 Sintex PU-50 Sealing and Bonding
- 31 Sintex PU-50 Professional
- 31 Sintex PU-60 Elastic Adhesive

## Synthetic Siliconised Sealants

- 32 Sintesel Multi-Purpose
- 32 Sintesel Miter Joints
- 33 Sintesel Wood

## Acrylics

- 34 Sintex AC-42 Construction Joints
- 34 Sintex AC-47 Joints and Cracks
- 34 Sintex AC-49 Granulated

## Miscellaneous Sealants

- 35 Polifix K-10 SL
- 35 Sintex AC-41 FIRE STOP
- 35 Sintex Fire Stop Refractory

## Accessories

- 36 OB High-Resistance Gun
- 36 Gun for Products Hard to Extrude
- 36 Economic Silicone Gun
- 37 Pro 600 ml Bag Gun
- 37 Pneumatic Cartridge Gun
- 37 B1 nozzle
- 38 Nozzle cartridge
- 38 Nozzle 360°
- 38 Fix Panels Tape
- 38 Politen Cel Backing Rod

## Primers

- 39 Primer C-27
- 39 Primer C-29
- 38 Primer C-15

## Cleaners

- 39 Dry Silicone Remover
- 40 Silicone Cleaner

# ORBASIL N-25

Windows and Facades



A world of colours for sealing of joints on windows and facades

## Orbasil N-25 Colour

Windows and Facades

High-performance neutral silicone sealant in colour. Certified AENOR N. ISO11600 F+G 25LM.

### Applications:

- Sealing in construction, glazing and windows (PVC, wood, aluminium, lacquered aluminium).
- Expansion joints on facades.
- Porous and non-porous materials.

### Advantages:

- Maximum elasticity and grip.
- Maximum resistance to weathering and UV rays. Permanent colour.
- Full range of colours.

Packaging	Content	Colour	Code No.	Code	EAN13 barcode No.	Units/box
Cartouche	300ml	Pyrenean White	T041087	10043426	8411729410872	24
		PVC White	T041095	10043427	8411729410957	24
		Copper	T041103	10043428	8411729411039	24
		Cream	T023051	10042998	8411729230517	24
		Pearl Grey	T023069	10042999	8411729230692	24
		Inox	T023077	10043000	8411729230777	24
		Brick	T041111	10043429	8411729411114	24
		Brown	T023085	10043001	8411729230852	24
		Pine	T023119	10043003	8411729231194	24
		Silver	T023127	10043004	8411729231279	24
		RAL 1013 Oyster White	T020834	10042922	8411729208349	24
		RAL 1015 Light Ivory	T008656	10042509	8411729086565	24
		RAL 3005 Wine Red	T097774	10043908	8411729977740	24
		RAL 5010 Gentian Blue	T098004	10043910	8411729980047	24
		RAL 6005 Moss Green	T014399	10042704	8411729143992	24
		RAL 6009 Fir Green	T099051	10043917	8411729990510	24
		RAL 7011 Iron Grey	T041137	10043431	8411729411374	24
		RAL 7016 Anthracite Grey	T071597	10043826	8411729715977	24
		RAL 7022 Umbra Grey	T041145	10043432	8411729411459	24
		RAL 7024 Graphite Grey	T041152	10043433	8411729411527	24
		RAL 8014 Sepia Brown	T041160	10042221	8411729411602	24
		RAL 8017 Chocolate Brown	T041178	10043435	8411729411787	24
		RAL 9006 White Aluminium	T005579	10042385	8411729055790	24
RAL 9007 Grey Aluminium	T011197	10042613	8411729111977	24		
RAL 9023 Pearl Dark Grey	T041186	10043436	8411729411862	24		
Oak	T023135	10043005	8411729231354	24		
Golden Oak	T027128	10043094	8411729271282	24		
Sapelly	T023168	10043006	8411729231682	24		
RAL 7021 Black Grey	T030684	10042385	8411729306840	24		
Black Forge	T023283	10043013	8411729232832	24		
Special Colour	consult			24		
Aluminium Bag	600ml	Beige PRE	T041467	10043443	8411729414672	12
		Pearl Grey	T027953	10043104	8411729279530	12





## Orbasil N-26

Windows and Facades

High-performance neutral silicone sealant for construction. **Certified AENOR N. ISO11600 F+G 25LM.**

### Applications:

- Sealing of doors and windows. Sealing of frames, glazing and carpentry – work.
- Expansion joints on facades.
- Sealing of PVC elements.
- Porous and non-porous materials: concrete, brick, wood, ceramic, glazed surfaces, aluminium, lacquered aluminium, steel, galvanized steel, painted surfaces and a variety of plastics.

### Advantages:

- Maximum elasticity and adherence.
- Maximum resistance to weathering and UV rays.
- Maximum performance for construction.

## Orbasil N-16

Construction and Windows

High-performance neutral silicone sealant for sealing windows and construction. **SNJF FG 25E. Certified AENOR N. ISO11600 F+G 25LM.**

### Applications:

- Sealing of doors and windows. Sealing of frames, glazing and carpentry – work.
- Expansion joints on facades.
- Sealing of PVC elements.
- Porous and non-porous materials.

### Advantages:

- High elasticity and adherence.
- High resistance to weathering and UV rays.
- High performance for construction.

## Orbasil N-09

General Use in Construction

Neutral silicone sealant for general use in construction.

### Applications:

- Sealing of static and expansion joints.
- Sealing of glazing, windows, and doors.
- Porous and non-porous construction materials.

### Advantages:

- Resistant to weathering and UV rays.
- Does not contract or crack.

## Orbasil N-26-S

Sanitary

Mould resistant neutral silicone sealant. **Certified AENOR N. ISO11600 F+G 25LM.** FDA CFR21 §177.2600(e) indirect contact with food.

### Applications:

- Sealing in bathrooms and kitchens, screens, shower trays, tiles, washbasins.
- Specially formulated for sealing in applications in critical environments, hospitals, laboratories, pharmaceutical industry, refrigeration units and dryers.

### Advantages:

- Mould resistant. Contains fungicide.
- Maximum resistance to weathering and UV rays.
- Maximum elasticity and adherence.
- Tested according to regulation FDA CFR21 §177.2600 (e) for indirect contact with foodstuffs.

## Orbasil N-36

Curtain Wall

Special neutral silicone sealant for sealing in curtain walls and structural glazing. **Certified AENOR N. ISO11600 F+G 25LM.**

### Applications:

- Waterproof sealant, resistant to weathering, for curtain walls, glazed facades, building facades and expansion joints.

### Advantages:

- Joint movement capacity of up to ±50%
- Maximum elasticity and adherence.
- Maximum resistance to weathering and UV rays.
- Compatible with double glass and structural glazing silicone.

Packaging	Content	Colour	Code	EAN13 barcode No.	Units/box
Cartridge	300ml	Translucent	10043788	8411729592202	24
		White	10043808	8411729619299	24
		Lacquered White	10042655	8411729128234	24
		Grey	10043809	8411729619374	24
		Black	10043807	8411729619039	24
Aluminium Bag	600ml	Translucent	10042760	8411729164515	12
		White	10042761	8411729164775	12

Packaging	Content	Colour	Code	EAN13 barcode No.	Units/box
Cartridge	300ml	Translucent	10043913	8411729983925	24
		White	10043884	8411729922627	24
		Lacquered White	10042188	8411729004309	24
		Grey	10043886	8411729935757	24
		Black	10043822	8411729703592	24
Aluminium Bag	600ml	White	10042723	8411729152307	12

Packaging	Content	Colour	Code	EAN13 barcode No.	Units/box
Cartridge	300ml	White	10043419	8411729409982	24
		Lacquered white	10043421	8411729410124	24
		Grey	10043422	8411729410209	24
		Black	10043423	8411729410384	24
		Translucent	10043420	8411729410049	24
		Aluminium Bag	600ml	White	10043417
		Grey TE	10043418	8411729409807	12

Packaging	Content	Colour	Code	EAN13 barcode No.	Units/box
Cartridge	300ml	Lacquered White	10043266	8411729357740	24
		Translucent	10043265	8411729357665	24
		White	10043550	8411729445034	24

Packaging	Content	Colour	Code	EAN13 barcode No.	Units/box
Cartridge	300ml	Black	10043243	8411729349189	24
Aluminium Bag	600ml	Black	10043619	8411729459222	12



## Orbasil Screens

Neutral silicone adhesive sealant for manufacturing bathroom screens.

### Applications:

- Specially designed for adhering the screen panels to the profile.
- All types of materials: glass acrylic panels, aluminium and steel profiles.

### Advantages:

- High modulus and rapid curing.
- Elastic joints that absorb movement between panel and profile.

Packaging	Content	Colour	Code	EAN13 barcode No.	Units/box
Aluminium Bag	400ml	Translucent	10042438	8411729066505	20

## Neutral Silicones



## Orbasil N-32 Mirrors

Special neutral silicone adhesive sealant for installing mirrors.

### Applications:

- Bonding and sealing of indoor mirrors and panels on different materials.

### Advantages:

- Does not stain the mirror.
- High resistance.
- Flexible, ultra-strong joints.
- Elastic, absorbs movement between panel and surface

Packaging	Content	Colour	Code	EAN13 barcode No.	Units/box
Cartridge	300ml	Translucent	10042233	8411729019822	24
		White	10042234	8411729019907	24



## Orbasil N-34 Structural Glazing

High-modulus neutral silicone sealant for structural glazing. **Certified EOTA 10-0196.**

### Applications:

- Specially designed for application on glued exterior glazed facades.
- Suitable for attaching glazing to a metal structure, following the system of glued exterior glazing for making light facades on both two and four sides.
- Bonding of glass in general applications, which require high performance.

### Advantages:

- Certified according to the DITE 002 guide for sealants used on structural glazing systems. Certified EOTA 10-0196.
- High mechanical resistance.
- Excellent resistance to UV radiation, extreme temperatures and weathering in general.
- High bonding power.

Packaging	Content	Colour	Code	EAN13 barcode No.	Units/box
Cartridge	300ml	Black	10043159	8411729312527	24

## Neutral Silicones



## Orbasil N-97 Windows and Glazing

High performance neutral silicone. **SNJF FG 25E. Certified AENOR N. ISO11600 F+G 25LM.**

### Applications:

- Windows and doors, aluminium, PVC and wood.
- Glazing joints.
- Ventilation ducts and gutters

### Advantages:

- 100% Silicone.
- Maximum resistance to weathering and UV rays.
- Low modulus, high elasticity.

Packaging	Content	Colour	Code	EAN13 barcode No.	Units/box
Cartridge	300ml	White	10042901	8411729203214	12
		Translucent	10042899	8411729201982	12



## Orbasil N-98 Windows and Facades

High-performance, alkoxy neutral silicone. **Certified AENOR N. ISO11600 F+G 25LM.**

### Applications:

- Sealing for windows and doors, ventilation ducts, gutters, expansion joints on facades.

### Advantages:

- 100% Silicone.
- Maximum resistance to weathering and UV rays.
- Low modulus, high elasticity.
- Bonds to plastics and difficult materials.
- Alkoxy technology.

Packaging	Content	Colour	Code	EAN13 barcode No.	Units/box
Cartridge	300ml	White	10042841	8411729183820	12
		Grey	10042848	8411729185985	12
		Black	10042880	8411729195137	12

## Orbasil N-39 Sealant for Polycarbonate

Complies with ISO 4599 / ISO 22088-3. Determination of resistance to environmental stress cracking (ESC) – Bent strip method..

### Applications:

- Sealing and waterproofing polycarbonate sheets in roofs.
- Sealing skylights.
- Sealing polycarbonate elements in general.

### Advantages:

- Does not damage polycarbonate nor reduces its flexibility.
- Fast curing.
- Neutral formula.
- Odor free.
- Non-corrosive.
- High durability.
- Mould resistant

Packaging	Content	Colour	Code	EAN13 barcode No.	Units/box
Cartridge	300ml	Translucent	10043347	8411729385965	24



EI 240



HT 315



## Orbasil N-28 Fire Stop

Heat-resistant neutral oxime silicone.  
**UNE EN 1366-4 / 13501-2. ISO11600 F+G 25LM.**

### Applications:

- Sealing of expansion joints on firewalls and slabs.
- Sealing of connections, pipes, conduits, etc., where fire protection is required.
- Sealing of firewalls.
- Sealing of fire doors.

### Advantages:

- Up to 4 hours fire resistance according to standard UN-1366-4.
- High resistance to weathering and UV rays.
- Elastic.

## Orbasil N-65 Fire Stop High Temperatures

Neutral silicone resistant to high temperatures.

### Applications:

- Bonding and sealing of panels, oven doors, smoke outlets, etc.
- Sealing of joints subjected to high temperatures: hot air or steam ducts, ovens, smoke outlets, oil sumps and water pumps.
- Bonding and sealing in refrigerators and boilers.
- Manufacture of solar panels

### Advantages:

- Resistant to temperatures up to 200°C continually and 315°C occasionally.
- Elastic.

## Orbasil K-95 Glazing

High-performance acid silicone.  
**Certified AENOR N. ISO11600 F+G 25LM.**

### Applications:

- Sealing in glazing.
- Sealing in metal structures, counters, glass cases and windows, refrigeration, ventilation and air conditioning components.

### Advantages:

- 100% Silicone.
- Maximum resistance to weathering and ageing.
- Permanent elasticity.
- Excellent bonding to glass, aluminium, tiles, ceramic, glazed surfaces and other non-porous surfaces.

## Orbasil K-91 Glazing

High-performance acid silicone.

### Applications:

- Glazing sealant.
- Sealing in metal structures, counters, glass cases and windows, refrigeration, ventilation and air conditioning components and small aquariums.

### Advantages:

- Elastic, lasting joints.
- Resistant to weathering and ageing.
- Excellent bonding to glass, aluminium, tiles, ceramic, glazed surfaces and other non-porous surfaces.

## Orbasil K-86 Multi-Purpose

Multi-purpose acid silicone.

### Applications:

- Sealing in glazing, sealing glass-aluminium joinery.
- Sealing in bathrooms and kitchens.

### Advantages:

- Mould resistant.
- Hermetic seal.
- Resistant to weathering and ageing.
- Excellent bonding to glass, aluminium, tiles, ceramic, glazed surfaces and other non-porous surfaces.

Packaging	Content	Colour	Code	EAN13 barcode No.	Units/box
Cartridge	300ml	White	10043150	8411729306762	24
		Pearl Grey	10003728	8411729241582	12
Aluminium bag	600ml	Pearl Grey	10043308	8411729367985	12

Packaging	Content	Colour	Code	EAN13 barcode No.	Units/box
Cartridge	300ml	Grey	10043032	8411729241742	12

Packaging	Content	Colour	Code	EAN13 barcode No.	Units/box
Cartridge	300ml	Translucent	10043779	8411729570002	24
		White	10043780	8411729570262	24

Packaging	Content	Colour	Code	EAN13 barcode No.	Units/box
Cartridge	300ml	Translucent	10043784	8411729590147	24
		White	10043799	8411729613334	24
		Aluminium	10043785	8411729590222	24
		Bronze	10043786	8411729590550	24
		Grey	10043787	8411729591212	24
		Black	10043800	8411729615987	24

Packaging	Content	Colour	Code	EAN13 barcode No.	Units/box
Cartridge	300ml	Translucent	10043803	8411729618124	24
		White	10043806	8411729618537	24
		Aluminium	10043804	8411729618209	24
		Copper	10043805	8411729618384	24
		Grey	10043801	8411729617059	24
		Black	10043802	8411729618049	24



HT 325



HT 315



## Aklesil

### Multi-Purpose

Multi-purpose acid silicone.

#### Applications:

- Sealing in glazing, sealing in glass-aluminium joinery.
- Sealing in bathrooms and kitchens.

#### Advantages:

- Resistant to weathering and ageing.
- Resistant to mould.
- Excellent bonding to glass, aluminium, tiles, ceramic, glazed and other non-porous surfaces.

## Orbasil K-88 Fire Stop

### High Temperatures

Acid silicone resistant to high temperatures.

#### Applications:

- Hot air or steam ducts up to 250°C.
- Ovens, smoke outlets, boilers, pump joints.
- Automobile industry: oil sumps and transmission boxes.

#### Advantages:

- Resistant to temperatures of 250°C continually and 325°C occasionally.
- Elastic.

## Orbasil Joint Former

Instant silicone joint former, resistant to high temperatures.

#### Applications:

- Bonds and substitutes cork, fibre and paper joints. For engines, gearboxes, ventilation systems and hydraulic equipment.

#### Advantages:

- Oil resistant.
- Resistant to temperatures up to 315°C.
- Fast curing.

Packaging	Content	Colour	Code	EAN13 barcode No.	Units/box
Cartridge	280ml	Translucent	10043781	8411729581565	24
		White	10043782	8411729581640	24
		Aluminium	10043888	8411729942502	24
		Bronze	10043887	8411729942434	24
		Black	10043889	8411729942687	24

Packaging	Content	Colour	Code	EAN13 barcode No.	Units/box
Cartridge	310ml	Red	10043795	8411729610449	12

Packaging	Content	Colour	Code	EAN13 barcode No.	Units/box
Tube Blister	85ml	Red	10043885	8411729925444	24

**10 YEARS' GUARANTEE**

**15 YEARS' GUARANTEE**

# PERFECT BATHROOM

Sanitary Neutral Silicone



## Silicone Multi-Purpose

Acid silicone sealant for home-use applications.

**Applications:**

- For sealing and filling all types of joints and cracks on baths, showers, bathroom screens, washbasins, kitchen units, sinks, glass cases and glazing.

**Advantages:**

- Mould-resistant.
- Stops leakage.
- Prevents the passage of air and dust.



## Silicone Bathrooms and Kitchens

Mould Resistant

High-quality acid silicone sealant recommended for application in areas with high humidity such as bathrooms and kitchens. It protects surfaces and actively prevents the formation of mould and blackening. It waterproofs, hermetically preventing leaks and resisting humidity, temperature and cleaning products.

**Applications:**

- Sealing of joints in bathrooms and kitchens:
- Joints in washbasins, baths, showers, screens or toilets.
- Joints in kitchen counters and sinks.

**Advantages:**

- 10 years anti-mould guarantee.
- Fast curing.
- Prevents water leakage.
- Elastic.
- Multi-position nozzle for application in difficult to access places.



## Perfect Bathroom Silicone

High quality silicone for sealing Kitchens and Bathrooms. Totally NEUTRAL, ideal for hermetic sealing on all types of materials, including most difficult and delicate ones, where conventional acid silicones can't be used. Hermetic, elastic and long-lasting sealing. **High mould resistance: up to 15 years of MOULDLESS warranty.**

**Applications:**

- Special for shower plates and screens, as well as kitchens worktops made of more delicate materials as marble, Wood, Silestone®, stone, slate...
- Bonds and seals hermetically on almost all porous and non-porous materials. Avoids water filtrations and prevents mould formation in joints, resisting to humidity and to commonly used cleaning products.

**Advantages:**

- Ultra-Fast: Dries in only 15 min.
- Odourless.
- Guarantee 15 years without mould.
- High durability
- Great range of colours.

Waterproofs hermetically, preventing leakage and resisting humidity, temperature and cleaning products.

**15 Years**

Guarantee 15 years without mould.

Odourless.

High durability



Ultra-Fast: Dries in only 15 min.

Packaging	Content	Colour	Code	EAN13 barcode No.	Units/box
Tube Blister	50ml	White	10042930	8411729210069	24
		Translucent	10042931	8411729210144	24
		Translucent	10042931	8411729210144	100 E*
Tube	85ml	White	10043044	8411729246129	24
		Blanc	10043043	8411729246044	24

Packaging	Content	Colour	Code	EAN13 barcode No.	Units/box
Tube	100ml	White	10043600	8411729455187	12
		Translucent	10043604	8411729455750	12
Cartridge	280ml	White	10042647	8411729124502	12
		Translucent	10042648	8411729124687	12

Packaging	Content	Colour	Code	EAN13 barcode No.	Units/box
Tube	100ml	White	10044238	8411729498092	12
		Translucent	10044239	8411729498177	12
Cartridge	280ml	White	10044721	8411729000653	12
		Translucent	10042893	8411729200572	12
		Anthracite	10042894	8411729200732	12
		Cream	10042895	8411729200817	12

\*E Reference on request from factory. Consult stocks and delivery points

MS Polymer Adhesive

# MS INSTANT

Elastic bonding

POLYMER  
**MS INSTANT**  
3s  
INSTANT GRIP



MS polymer adhesive for elastic bonding. For instant grip where resistant, flexible anchorage is required. Excellent adherence to most materials



## MS Instant

High initial tack MS polymer adhesive for ultra resistant bonding of elements both vertically and horizontally.

### Applications:

- For instant bonding that requires resistant, flexible glue.
- Metal and plastic pieces, panels, sheet metal, mirrors, insulation panels, prefab elements, agglomerate panels and industrial bodywork.

### Advantages:

- Immediate tack: 3 seconds.
- Ultra resistant: 300 Kg/10cm<sup>2</sup>.
- Bonds even on wet surfaces and under water.
- Elastic: absorbs vibrations and movement of expansion and contraction.
- Multi-material.
- Free of isocyanates and solvents.

Packaging	Content	Colour	Code	EAN13 barcode No.	Units/box
Cartridge	280ml	White	10043307	8411729367800	12
Aluminium Bag	600ml	White	10043306	8411729367312	12

## Sintex MS-35 Bonding and Sealing

MS polymer for elastic bonding and sealing.

### Applications:

- Elastic bonding and sealing of construction elements (tiles, baseboards, interior and exterior panels).
- Sealing of joinery.
- Sealing of metal roofing.
- Joints in passable flooring.
- Non-structural sealing of caravans, container bodywork and industry in general.

### Advantages:

- Bonds and seals even on wet surfaces and under water.
- Paintable.
- High mechanical resistance
- 600% elasticity.
- Resistant to weathering and UV rays.
- Multi-material.
- Free of isocyanates and solvents.

Packaging	Content	Colour	Code	EAN13 barcode No.	Units/box
Cartridge	300ml	White	10043798	8411729613259	24
		Grey	10043791	8411729600204	24
		Brown PU	10042929	8411729209827	24
		Black	10043797	8411729612917	24
Aluminium Bag	600ml	White	10043904	8411729966935	12
		Grey	10043907	8411729971052	12



Product video

## Sintex MS Transparent

Transparent bonding and sealing MS.

### Applications:

- Elastic joints.
- Bonding and sealing of most materials: concrete, brick, cement, aluminium, steel, zinc, polycarbonate, glass, ceramic and other materials.
- Construction joints for bathrooms, pipes, skylights..

### Advantages:

- Bonds even on wet surfaces.
- 300% Elastic.
- Resistant to weathering.
- Multi-material.
- Free of isocyanates and solvents

Packaging	Content	Colour	Code	EAN13 barcode No.	Units/box
Cartridge	280ml	Transparent	10043314	8411729369705	24



**Sintex MS-20**  
Construction Joints

Low-modulus, high-elasticity MS polymer sealant for sealing construction joints.

**Applications:**

- Expansion joints in buildings under construction and prefab elements.
- Joinery building frames.
- Joints on non-passable flooring.
- Joints on balconies and terraces.

**Advantages:**

- Seals even on wet surfaces.
- High resistance to weathering and UV rays.
- Elastic, paintable joints.
- Does not stain joint edges.
- Excellent adherence to most construction materials.
- Free of isocyanates and solvents.

Packaging	Content	Colour	Code	EAN13 barcode No.	Units/box
Cartridge	300ml	White	10043894	8411729956615	24
		Grey	10043895	8411729956790	24
Aluminium Bag	600ml	White	10043903	8411729966775	12
		Grey	10043819	8411729697655	12



**Sintex MS-33**  
Mirrors

MS polymer adhesive sealant for bonding mirrors or panels.

**Applications:**

- Bonding and sealing of indoor mirrors and panels on most materials: melamine, glass, ceramic, mortar, wood, polyester, PVC, metals.

**Advantages:**

- Does not stain the mirror coating.
- High initial tack.
- Absorbs vibrations.
- Adherence to difficult materials such as melamine.
- Free of isocyanates and solvents.

Packaging	Content	Colour	Code	EAN13 barcode No.	Units/box
Cartridge	300ml	Grey	10043792	8411729600617	24



**Sintex MS-52**  
Structural Bonding

MS polymer elastic adhesive for industrial bonding.

**Applications:**

- Automobile industry: Bodywork construction and repair, caravans.
- Manufacture of containers.
- Shipbuilding.
- Industry in general

**Advantages:**

- Absorbs vibrations and reduces noise.
- High initial tack.
- High adherence to most surfaces.
- Free of isocyanates and solvents.

Packaging	Content	Colour	Code	EAN13 barcode No.	Units/box
Aluminium Bag	600ml	White	10042862	8411729188795	12 E*

\*E Reference on request from factory. Consult stocks and delivery points

# MS FIX PANELS ADHESIVE

Assembly of light, ventilated facades

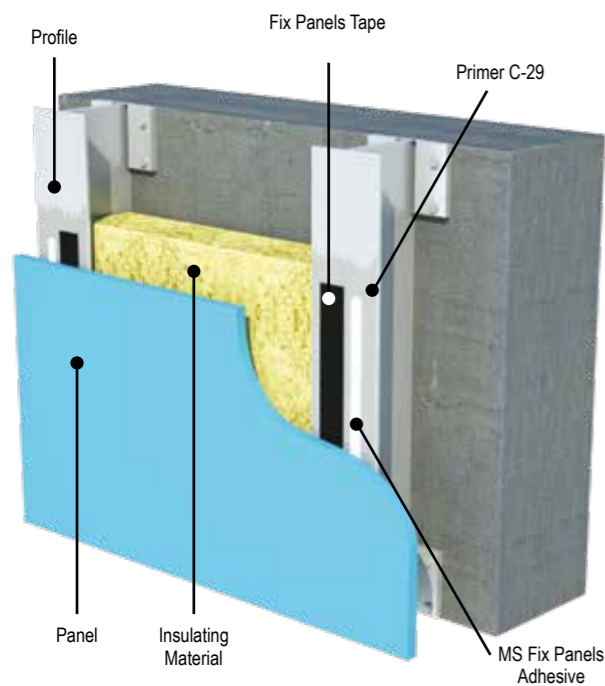

**Product certified on facades with wind pressure and suction tests according to ETAG 034**



## Fix Panels MS Adhesive

MS based elastic adhesive for bonding panels on light facades.

**Applications:**

- Bonding panels for light facades on different materials, composite, ceramic, wood or fibre-cement.
- Interior and exterior use

**Advantages:**

- High mechanical resistance.
- High initial tack, allowing rapid bonding of the panel.
- Absorbs movements and vibrations.
- Resistant to humidity and temperature changes.

## FIX Panels Tape

Double-sided PE foam tape for installing light facades together with the FIX PANELS adhesive.

**Applications:**

- Specially for initial bonding of the panel until the adhesive reaches maximum performance.

**Advantages:**

- High resistance.
- Thickness: 3mm; Width: 12mm.

## Primer C-29

Primer for silicone and MS polymer sealants on different types of plastic and metal surfaces.

**Applications:**

- Cleaning and pre-treatment of composite panels on light facades before application of the adhesive

**Advantages:**

- Provides the best conditions for bonding the panel.

High initial tack: rapid bonding to the panel.

Absorbs movement and vibrations.

Resistance to humidity and changes in temperature.

Allows new designs (curved constructions, etc.) not feasible with mechanical bonding.

Hidden bonding offering aesthetic benefits.

Packaging	Content	Colour	Code	EAN13 barcode No.	Units/box
Cartridge	280ml	White	10043172	8411729319229	24
Aluminium Bag	600ml	White	10043293	8411729362935	12

Packaging	Content	Code	EAN13 barcode No.	Units/box
Roll	20m	10043173	8411729319304	25

Packaging	Content	Code	EAN13 barcode No.	Units/box
Bottle	950ml	10043768	8411729500627	4



# 1000 USES & SUPER FIX MS POLYMER

BONDS AND SEALS EVERYTHING EVEN UNDER WATER



Bonds even on wet surfaces



Super-elastic



Resistant to weathering and UV



Mould-resistant



MS polymer adhesive and sealant for all types of applications.

Free of hazardous substances.

Ultra-resistant

Bonds to most materials.



## 1000 USES & SUPERFIX MS Bonds Seals All

MS polymer for bonding and sealing in all types of applications.

### Applications:

Bonds and seals everything:

- Sealing of construction joints, joinery, gutters, baths, cracks, pipes, skylights.
- Bonding of metal and plastic pieces, panels, mirrors, insulation sheets, agglomerate panels, boards and veneers.
- All types of materials: brick, tiles, concrete, metal, plastics, marble, granite, polystyrene, polycarbonate, glass, PVC, DM wood, aluminium, ceramic, mirrors.

### Avantages:

- Bonds even under water.
- Super elastic: 500%.
- Super resistant: 250 kg/10cm2.
- Absorbs vibrations and expansion and contraction movement.
- Resists weathering and temperature (-40°C + 90°C).
- Multi-position nozzle for application in places difficult to access.
- Free of hazardous substances.

### 1000 USES

Packaging	Content	Colour	Code	EAN13 barcode No.	Units/box
Tube	100ml	White	10024497	8411729455835	12
Cartridge	280ml	White	10042332	8411729038892	12
		Grey	10043222	8411729339692	12
		Brown	10043219	8411729338374	12
		Black	10042343	8411729040369	12
		Tile	10043223	8411729339777	12

### SUPERFIX MS

Packaging	Content	Colour	Code	EAN13 barcode No.	Units/box
Cartridge	280ml	White	10042332	8411729038892	12 E*
		Black	10042343	8411729040369	12 E*



## 1000 USES & SUPERFIX MS Bonds Seals Invisible

Transparent MS polymer for bonding and sealing.

### Applications:

Transparent bonding and sealing:

- Sealing of all types of construction joints, glass, bathrooms, pipes, skylights.
- Bonding of glass, metal, plastics.
- Adhesion to most materials: Cement, aluminium, steel, zinc, polystyrene, polycarbonate, glass, ceramic, concrete, brick, wood, PVC.

### Avantages:

- Bonds even on wet surfaces.
- Resistant to weathering and temperature (-40°C + 90°C).
- Mould-resistant.
- Elastic: Absorbs vibration, expansion and contraction movement.
- Multi-position nozzle for application in places difficult to access.
- Odourless.
- Free of hazardous substances.

### 1000 USES

Packaging	Content	Colour	Code	EAN13 barcode No.	Units/box
Tube	100ml	Transparent	10024496	8411729455910	12
Cartridge	280ml	Transparent	10036018	8411729176402	12

### SUPERFIX MS CRISTAL

Packaging	Content	Colour	Code	EAN13 barcode No.	Units/box
Cartridge	280ml	Transparent	10042351	8411729042189	12 E*

\*E Reference on request from factory. Consult stocks and minimum quantity order.



Product video



## Sintex PU-40 PRO

### Professional

Low-modulus, high-quality polyurethane sealant for construction joints.  
**Certified AENOR N. ISO11600 F 25 LM.**

#### Applications:

- Sealing of joints with movement and joints both for indoor and outdoor applications. Facades, prefab panels, wall-floor joints, non-passable floor joints.

#### Advantages:

- Paintable.
- High capacity of joint movement.
- Resistant to contraction and expansion movement.
- Excellent adherence to most construction materials.
- Innovative technology that prevents bubbles in joints.
- Prevents slumping in vertical joints.

## Sintex PU-50

### Sealing and Bonding

Medium-high-modulus polyurethane for bonding and sealing.

#### Applications:

- Elastic sealing and bonding in construction and industry.
- Bonding of construction elements (tiles, screens, skirting boards).
- Expansion and static joints.
- Sealing of framework and joinery.
- Joints in passable floors.
- Elastic sealing and bonding in industry (ventilation, air conditioning, automobile, containers, metal components).
- Excellent adherence to cement, brick, ceramic, metal, wood, polyurethane foam, epoxy and some polyesters.

#### Advantages:

- Strong and elastic, 2 in 1.
- Paintable.
- Interior and exterior.
- Absorbs vibrations and expansion movement.

## Sintex PU-50

### Professional

High-quality polyurethane adhesive sealant for bonding and sealing.

#### Applications:

- Elastic sealing and bonding in construction and industry.
- Bonding of construction elements (tiles, screens, skirting boards).
- Expansion and static joints.
- Sealing of framework and joinery.
- Joints in passable floors.
- Elastic sealing and bonding in industry (ventilation, air conditioning, automobile, containers, metal components).
- Excellent adherence to cement, brick, ceramic, metal, wood, polyurethane foam, epoxy and some polyesters.

#### Advantages:

- Strong and elastic, 2 in 1.
- Paintable.
- Interior and exterior.
- Absorbs vibrations and expansion movement.
- Innovative technology that prevents bubbles in joints.
- Prevents slumping in vertical joints.

## Sintex PU-60

### Elastic Adhesive

High-modulus elastic polyurethane adhesive.

#### Applications:

- Elastic bonding in construction and industry.
- Construction and repair of chassis, caravans, containers, shipbuilding.
- Windowsills, panels, stairways, baseboards, tiles, skirting and parquet.

#### Advantages:

- High resistance, up to 250kg/10cm<sup>2</sup>.
- High initial tack.
- Absorbs knocks and vibrations.
- Able to withstand dynamic force.
- Excellent gap-filling capacity.

Packaging	Content	Colour	Code	EAN13 barcode No.	Units/box
Aluminium Bag	600 ml	White	10042978	8411729222932	12
		Grey	10042959	8411729216917	12
		RAL 1015 Light Ivory	10042589	8411729105532	12
		Black	10042590	8411729105877	12
		Concrete Grey	10043246	8411729351212	12
		Cartridge	300 ml	White	10043609
		Grey	10043610	8411729944667	12

Packaging	Content	Colour	Code	EAN13 barcode No.	Units/box		
Cartridge	300ml	White	10043605	8411729949044	12		
		Grey	10043606	8411729944742	12		
		Brown	10043607	8411729999520	12		
		Black	10043608	8411729944827	12		
		Tile	10042336	8411729039547	12		
		RAL 1015 Light Ivory	10042338	8411729039707	12		
		Aluminium Bag	600ml	White	10043237	8411729345617	12
				Grey	10003751	8411729345792	12
				Brown	10043238	8411729345877	12
				Black	10043239	8411729345952	12
				RAL 1015 Light Ivory	10043625	8411729461027	12

Packaging	Content	Colour	Code	EAN13 barcode No.	Units/box
Aluminium Bag	600ml	Grey	10042591	8411729106034	12
		White	10043237	8411729440992	12

Packaging	Content	Colour	Code	EAN13 barcode No.	Units/box
Cartridge	300ml	White	10042341	8411729040109	12
Aluminium Bag	600ml	White	10043304	8411729365820	12



## Sintesel Multi-Purpose

Water-based multi-purpose sealant.

**Applications:**

- Perimeter joinery joints.
- Wall-ceiling intersections and baseboards.
- Joints between tiles, panels and bathroom floors.
- Sealing of cracks.

**Advantages:**

- Odourless.
- Paintable.
- Good resistance to weathering.
- Interior and exterior.

## Sintesel Miter Joints

Water-based adhesive for sealing-cutting miter joints and fine joints in metal, wood, PVC joinery.

**Applications:**

- Sealing of miter joints in aluminium (anodized, lacquered), wood and PVC materials.

**Advantages:**

- Easy to apply.
- Resistant to ultraviolet rays.
- Resistant to water once dry.
- Bonds to aluminium (lacquered, anodized), wood and PVC.
- White when applied, it becomes transparent when dry.
- Solvent free.
- Easy cleaning with water.
- Odourless.

## Sintesel Wood

Water-based sealant for wooden joints.

**Applications:**

- Finishing and sealing joints in parquet, baseboards, skirting, cupboards and wooden pieces.
- Sealing of joints between wood and joinery (doors, windows, etc.).

**Advantages:**

- Paintable and varnishable.
- Extensive range of wood colours.
- Extendable up to 1000%.
- Good resistance to weathering.
- Interior and exterior.

Packaging	Content	Colour	Code	EAN13 barcode No.	Units/box
Cartridge	300ml	White	10043864	8411729873875	24
		Translucent	10043778	8411729541897	24

Packaging	Content	Colour	Code	EAN13 barcode No.	Units/box
Bottle	500grs	Translucent	10042506	8411729083670	12

Packaging	Content	Colour	Code	EAN13 barcode No.	Units/box
Tube	150ml	Pine	10044392	8411729446284	12
		Cancun Linen	10042685	8411729136727	12
		Beech	10044390	8411729446024	12
		Oak	10044393	8411729446369	12
		Cherry	10044389	8411729445942	12
		Sapelly	10044394	8411729446444	12
		Light Oak Grey	10044396	8411729446932	12
		Dark Oak Grey	10044657	8411729447014	12
		Walnut	10044395	8411729446512	12
		White	10044391	8411729446109	12

Packaging	Content	Colour	Code	EAN13 barcode No.	Units/box
Cartridge	300ml	Pine	10043714	8411729882037	12
		Cancun Linen	10042685	8411729136727	12
		Beech	10043712	8411729121532	12
		Chestnut	10042686	8411729136802	12
		Oak	10043716	8411729881207	12
		Cherry	10043711	8411729121617	12
		Sapelly	10043715	8411729882600	12
		Walnut	10043713	8411729121792	12
		Wenge	10043717	8411729309817	12
		Light Oak Grey	10043709	8411729485870	12
		Dark Oak Grey	10043710	8411729485955	12
		White	10043708	8411729485795	12



## Sintex AC-42

### Construction Joints

Acrylic sealant for sealing low-movement construction joints.  
**Certified SNJF F 12,5P and ISO 11600 F 12,5 P.**

#### Applications:

- Low-movement joints not subjected to traffic: light and heavy prefab, masonry.
- Perimeter joinery and duct joints.
- Joints between panels and tiles.
- Sealing and filling of cracks.
- Interior y exterior

#### Advantages:

- Paintable and varnishable.
- Good adherence to porous materials.

## Sintex AC-47

### Joints and Cracks

Acrylic for sealing and filling joints and cracks.

#### Applications:

- Sealing of joints with low movement.
- Cracks in facades and walls.
- Sealing of roll blind boxes, door and window frames.
- Interior and exterior.

#### Advantages:

- Easy to apply.
- Excellent resistance to weathering.
- Paintable.
- Good adherence to porous materials.
- Does not crack.

## Sintex AC-49

### Granulated

Granulated acrylic for sealing and filling joints and cracks.

#### Applications:

- Sealing of joints with movement less than 10%.
- Sealing of joinery.
- Interior and exterior.
- Sealing and filling of cracks in plaster and masonry.

#### Advantages:

- Granulated texture.
- Easy to apply.
- Excellent resistance to weathering.
- Paintable.
- Good adherence to porous materials.
- Does not crack..

## Polifix K-10 SL

Self-levelling, two-component polysulphide sealant.

#### Applications:

- Sealing of horizontal static and expansion joints in construction and civil works: Airports, runways and hangars, ports, roads and bridges, treatment plants, joints in workshops, garages, vehicle parkings.
- Industrial paving.
- Heavy vehicle parkings.

#### Advantages:

- Excellent chemical resistance
- Excellent resistance to abrasion and mechanical tear
- Excellent resistance to weathering.

## Sintex AC-41

### FIRE STOP

Fire-resistant acrylic sealant.  
**Classified EI 240 according to UNE EN 1366-4 / 13501-2.**

#### Applications:

- Sealing of low-movement joints in firewalls and slabs.
- Sealing of connections, metal pipes, cable installations, door or window frames that require protection against fire.

#### Advantages:

- Up to 4 hours fire resistance.
- Paintable.

## Sintex Fire Stop

### Refractory

Putty resistant to high temperatures and direct flame.

#### Applications:

- Permanent repair and sealing of joints, cracks and fissures in chimneys, heating units, conduits, refractory elements, etc.

#### Advantages:

- Resistant to 1,500°C
- Fire-proof

Packaging	Content	Colour	Code	EAN13 barcode No.	Units/box
Cartridge	300ml	White pure	10043821	8411729703264	24
Aluminium Bag	600ml	Grey	10043105	8411729279615	12

Packaging	Content	Colour	Code	EAN13 barcode No.	Units/box
Cartridge	300ml	White	10042656	8411729520014	24
		Sharp white	10042656	8411729300074	24
		Grey	10043772	8411729520274	24
		Brick	10043775	8411729520687	24
		Brown	10043773	8411729520359	24
Aluminium Bag	600ml	Black	10043774	8411729520502	24
		White	10043900	8411729959685	12
		Grey	10043901	8411729959760	12
		Beige PRE	10043267	8411729357825	12
		RAL 9002	10043290	8411729361600	12

Packaging	Content	Colour	Code	EAN13 barcode No.	Units/box
Cartridge	300ml	White	10042656	8411729128562	12

Packaging	Content	Colour	Code	EAN13 barcode No.	Units/box
Drum Part A	13 l	Grey	10043134	8411729301552	1
Drum Part B	680ml	Grey	10043135	8411729301637	12

Packaging	Content	Colour	Code	EAN13 barcode No.	Units/box
Cartridge	300ml	Pearl Grey	10043033	8411729241827	24
Aluminium Bag	600ml	White	10043375	8411729393472	12
		Pearl Grey	10043149	8411729306687	12
		Beige PRE	10043269	8411729358167	12

Packaging	Content	Colour	Code	EAN13 barcode No.	Units/box
Cartridge	300ml	Black	10043269	8411729241902	12



### Ob Gun

High Resistance

High-resistance gun.

### Gun for Products Hard to Extrude

High-resistance gun for applying high -viscosity products.

### Gun

Economic

Manual gun for home applications.

### Pro 600ML Bag Gun

Gun for applying sealants in aluminium bags.

### Pneumatic Cartridge Gun

Pneumatic gun for applying sealants in cartridges and aluminium bags (400ML) and for aluminum bags (600ML).

### B1 Nozzle

Applicator nozzle for sealant in aluminium bags.

Packaging	Code	EAN13 barcode	Units/box
Unit	10043856	8411729733537	6

Packaging	Code	EAN13 barcode	Units/box
Unit	10043095	8411729271367	1

Packaging	Code	EAN13 barcode	Units/box
Unit	10043859	8411729736682	12

Packaging	Code	EAN13 barcode	Units/box
Unit	10043858	8411729735937	1

Packaging	Content	Code	EAN13 barcode	Units/box
Unit	600ml	10043920	8411729967307	1
	400ml	10043919	8411729996222	1 E*

Packaging	Code	EAN13 barcode	Units/box
Unit	10043857	8411729734114	10

## Nozzles and Backing Rod



### Nozzle Cartridge

Nozzle for applying sealants by cartridge.

### Nozzle 360° Cartridge

Allows to apply the product in hard-to-reach areas.

**Applications:**

- Screw cap to keep the product fresh.

### Politen Cel Backing Rod

Polyethylene filling cord for joint bases. Available in different diameters.

Packaging	Code	EAN13 barcode No.	Units/box
Unit	10043225	8411729342807	24

Packaging	Code	EAN13 barcode No	Units/box
Unit	10042398	8411729059002	3

Packaging	Content	Code	EAN13 barcode No	Units/box
Box	1150m x 10mm	10043850	8411729732707	1
	550m x 15mm	10043154	8411729309404	1
	350m x 20mm	10043851	8411729732967	1
	200m x 25mm	10043852	8411729733049	1
	160m x 30mm	10043853	8411729733124	1
	270m x 40mm	10043854	8411729733209	1
	180m x 50mm	10043855	8411729733384	1

## Primers



### Primer C-27

Primer for silicone and MS polymer sealants.

**Applications:**

- Application on porous materials (cement, brick, wood, etc.) and some non-porous materials (metals and some plastics) where perfect adhesion of sealant is required.

Packaging	Content	Code	EAN13 barcode	Units/box
Bottle	950ml	10043769	8411729500702	4

### Primer C-29

Primer for MS polymers and silicones on a various kind of plastic and metal surfaces.

**Applications:**

- Preparation of rigid or flexible PVC, polyacrylate surfaces and other plastics (except polyethylene) and certain metals before sealing.
- Cleaning and pre-treatment of light facade composite panels before applying the adhesive.

Packaging	Content	Code	EAN13 barcode	Units/box
Bottle	950ml	10043768	8411729500627	4

### Primer C-15

Primer based on dissolved polyurethane resins.

**Applications:**

- Improves the adherence of polyurethane and polysulphide sealants on porous materials such as concrete, brick, mortar, wood, etc. Or over remains of old sealants.

Packaging	Content	Code	EAN13 barcode	Units/box
Bottle	1l	10043770	8411729501792	4



## Remover for Dry Silicone

Removes sealant cord of acid and neutral silicone, polyurethane, MS polymer and water base.

### Applications:

- Suitable for removing remains of old sealant prior to renewing and re-sealing deteriorated joints.

Packaging	Content	Code	EAN13 barcode No.	Units/box
Tube w/Blister	85ml	10042925	8411729208752	12



## Cleaner for Silicone

Cleaner for cords of cross-linked sealants.

### Applications:

- Cleans sealant cord of acid and neutral silicone, polyurethane, MS polymer.
- Removes remains of fresh sealant.

Packaging	Content	Code	EAN13 barcode No.	Units/box
Aerosol	150ml	10042967	8411729220464	12

## PROFESSIONAL SEALANTS

### Comparative Table

PROPERTIES SEALANTS	NEUTRAL SILICONE	ACID SILICONE	ACRYLIC SEALANT	PU SEALANTS	HEAT-PROOF PUTTY	MS SEALANTS
PAINTABLE	No	No	Yes	Yes	No	Yes
JOINT MOVEMENT	High	High	Low	High	Low	High
RESISTANCE TO WEATHERING	Excellent	Excellent	Regular	Very Good	Very Good	Very Good
ADHERENCE WITHOUT PRIMER	Very Good	Very Good	Good	Excellent	Good	Excellent
ADHERENCE WHEN WET	No	No	No	No	No	Yes
ELASTICITY	Very Good	Very Good	Regular	Very Good	Average	Very Good
APPLICATION MATERIALS	All	Non - Porous	Porous	All	All	All
TEMPERATURE	+5 to +50°C	+5 to +50°C	+5 to +50°C	+5 to +50°C	+5 to +50°C	+5 to +50°C
RESISTANCE TO WEATHERING	-50 to +150°C	-50 to +150°C	-20 to +80°C	-40 to +90°C	-40 to +1.500°C	-40 to +90°C

## THREE BARRIER INSTALLATION SYSTEM



### Professional Window and Door System

- 51 Orbafoam Ultra Fast
- 51 Orbafoam Pro-Energy
- 52 Orbafoam Controlled Expansion
- 52 Orbafoam Pro-Windows

### Three-Barrier Insulation System

- 53 Self-expanding tape ORBAFOAM BG1 600
- 53 Waterproofing Film ORBAFOAM

Inefficient installation of windows in buildings is one of the most common causes of energy loss in homes. A poorly-sealed window or door can represent up to 25% of energy loss in a home. One effective solution to this problem is a system of installing windows and doors that guarantees major energy savings and improves comfort of life for years.

Selena offers several systems for installing windows and doors, developed for different environments, including the energy efficiency system certified by the Building Research Institute of Warsaw. Selena has also developed a wide range of PU foams and accessories for different requirements, creating new standards of quality.



# INSULATION SYSTEM. THREE-BARRIER

## Energy Rehabilitation and Sustainable Construction

% Heat loss



Complete professional system that eliminates thermal bridges as efficiently and permanently as possible, reducing energy loss and providing greater habitability, hygiene and comfort to homes, with the consequent energy saving. It offers excellent thermal and acoustic insulation in installing windows and doors on site. It is suitable for any type of framework: aluminium, PVC or wood.

This system also ensures permeability to vapour from inside out, preventing the condensation of continuous humidity that may cause fungus or even to destroy construction materials.

### THREE-BARRIER INSULATION SYSTEM:

#### ORBAFOAM PRO-ENERGY:

„Pro-Energy” state of the art in polyurethane foam, achieving maximum thermal and acoustic insulation. It provides up to 60% ENERGY SAVING \*

#### WATERPROOF FILM:

Laminated polyurethane on a felt strip in two versions:

- INTERIOR: Film impermeable to air and vapour whose main function is to ensure sealing against moisture from inside to the intermediate insulation layer, keeping it dry.
- EXTERIOR: Watertight barrier against wind and rain. Permeable to vapour from inside out, to allow the passage of residual humidity. Resistant even to torrential rain.

#### ORBAFOAM SELF-EXPANDING TAPE:

- THREE-BARRIER TAPE: Complete assembly system using three insulation levels (interior, intermediate and exterior) combining all requirements according to RAL and EnEV installation (energy saving regulation) in one product.

- BG1: Pre-compressed, self-expanding polyurethane foam tape 600 Pa.

#### SINTEX MS-35 SEALANT: SEALING AND BONDING.

MS technology elastic sealant ideal for sealing perimeter window joints and bonding the waterproof film. It has adhesion even on wet surfaces and under water. Paintable. Excellent adherence to materials both porous and non-porous. 600% elastic



#### IMPROVEMENT OF INSTALLATION EFFICIENCY

- ▶ Durable thermal and acoustic insulation.
- ▶ Air and water sealing and vapor control.
- ▶ Resistance even to torrential rain.

Polyurethane acts like a film that regulates humidity being waterproof to water but permeable to the water vapour. The level of vapour permeability depends on the density of the foam and how compact the cell is. The structure of PRO-ENERGY foam cells makes it ideal, in any climatic conditions, creating enough resistance to the vapour to prevent condensation.

**✗ Without  
THREE-BARRIER  
System**



**✓ With  
THREE-BARRIER  
System**



Find out how to install our system with this video:



\* Value based on energy efficiency calculations of insulation between the window frame and the wall using ORBAFOAM PRO-ENERGY and other standard foams.

# Polyurethane Foam **ULTRA FAST 70**

For the "ULTRA FAST"  
instalation of windows and doors

**ULTRA FAST WORK**



**Yield 70l. +**

**Ready for cutting in  
70 mins.**

**Up to 63dB of  
acoustic sealing.**

**Controlled expansion.**



## ORBAFOAM Ultra Fast

A fast-dry polyurethane foam, Ultra Fast 70 is specially suitable for the swift installation of Windows and Doors. Orbafoam Ultra Fast 70 is the foam with highest yield in the market: you'll be able to get more windows and doors installed with just a single canister, meaning greater savings in both time and money.

**Aplicaciones:**

- Professional installation of windows and doors. Specially suitable for jobs that need to get done as quickly as possible in a clean and efficient way.

**Ventajas:**

- High yield: 70l. +9,3 linear meters.
- Ultra-fast hardening: expansion stops in 6 mins. and the excess foam can be cutted out after 10 mins.
- Completely hardened in 90 mins.
- Controlled expansion: avoid frames' malformations and product waste.
- Excellent cell-based structure.
- Suitable temperature for application: 5°C - 30°C.
- 63dB Soundproofing.
- 0,036 [W/m\*K] λ. Thermal Insulation.

Packaging	Content	Colour	Code	EAN13 barcode No.	Units box
Gun canister	870 ml	Amarillo	10041969	8411729487690	12

**60% TILL  
ENERGY SAVINGS**



## ORBAFOAM Pro-Energy

Professional PU foam for installing windows and doors. With 60 % energy saving.

**Aplicaciones:**

- Professional installation of windows and doors where the best thermal and acoustic insulation values are required. Precise application due to its controlled expansion, with maximum performance, preventing deformations in doors and windows frames.

**Advantages:**

- Energy saving. It eliminates thermal bridges as efficiently and permanently as possible, reducing energy loss up to 60% in joinery insulation.
- Excellent acoustic insulation 64dB.
- Extraordinary adherence to PVC (+ 300%)
- Controlled expansion.
- Compact and homogeneous cells.
- Fast curing: 25 min.
- Suitable for winter use -10°C to +35°C.
- Shelf life: 18 months

Packaging	Content	Colour	Code	EAN13 barcode No.	Units box
Gun canister	750 ml	Blue	10026579	8411729022617	12



Product video



## ORBAFOAM Controlled Expansion

Professional PU foam for installing windows and doors, yield of 55 litres. Application with gun.

### Applications:

- Professional installation of windows and doors. Due to his superior yield of 55LT with controlled expansion, it maximizes the yield while avoiding deformations in windows and doors frames.

### Advantages:

- High yield up to 55L.
- Thermal and acoustic insulation.
- Certified acoustic insulation 60dB.
- Controlled expansion.
- Fast curing: 25 min.
- Shelf life: 18 months.

## ORBAFOAM Pro-windows

Polyurethane foam for installing doors and windows.

### Applications:

- Installation of windows and doors with excellent adherence to all types of construction materials, straw application.

### Advantages:

- Flexible.
- Ergo straw. Re-usable 60 days.
- Total ergonomic control.
- Thermal and acoustic insulation.
- Shelf life: 12 months.

Packaging	Content	Colour	Code	EAN13 barcode No.	Units nbox
Gun canister	750 ml	Yellow	10026101	8411729022577	12

Packaging	Content	Colour	Code	EAN13 barcode No.	Units box
Aerosol for straw	750 ml	Yellow	10040442	8411729106294	12

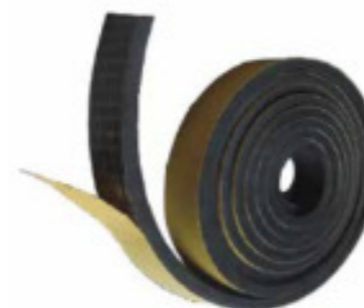

## Self-Expanding Tape ORBAFOAM BG1 600

Pre-compressed self-expanding polyurethane foam.

### Applications:

- After application, the tape expands by decompression, with no chemical reaction, filling the gap between the window frame and the wall, leaving it tight.
- It has been specially designed for reliably sealing joints in buildings and facades. It can be used in installations of aluminium, PVC and wooden frames..

### Advantages:

- Tested as a BG1 sealing tape that complies with the high requirements of standard DIN 18542: 2009.
- Waterproof to torrential rain of more than 600Pa (corresponding to a wind force 11).
- Airtight and impermeable to water but permeable to water vapour.
- Resistant to UV rays.
- Thermal and acoustic insulation.
- Fire classification DIN1402 B1.

### BG1

Size mm	Length metres	Colour	Code	EAN13 barcode No.	Units box
15x3/15	10	Black	10042263	8411729026424	1
25x8/40	4,3	Black	10042264	8411729026677	1
30x5/12	5,6	Black	10042936	8411729211882	1

## Waterproof Film ORBAFOAM

Laminated polyurethane watertight membrane on a felt band with butyl. Measurements 100mm X 30m.

### Applications:

- INTERIOR: Air and vapour-proof film whose main function is to ensure tightness against humidity and vapour from inside till the intermediate insulation layer, keeping it dry. Resistance to vapour, Sd > 55m PN-IN 1931. Colour Pink.
- EXTERIOR: Airtight barrier against wind and rain. Permeable to vapour from inside out to allow the passage of residual humidity. Resistant even to torrential rain. Resistance to vapour, Sd < 0,05m PN-IN 1931. White colour.

### Advantages:

- Easy to use.
- May be painted or plastered.

Size mm	Length metres	Colour	Code	EAN13 barcode No.	Units box
Exterior 100x30	30	White	10042262	8411729026349	1
Inside 100x30	30	Pink	10042257	8411729025762	1
Mixed 70x30	30	White	10043520	8411729440572	1

## POLYURETHANE FOAMS



Quilosa offers a wide range of multi-purpose and professional foams, making it one of the market leaders, creating new trends and setting high standards of quality.

Quilosa was the first company to present the innovative high-yield technology.

Our foams have O2 and M1 certificates that guarantee safety in using these products.

### Professional PU Foams

- 57 Orbafoam Pro 45 / Pro 25 / Pro 15
- 58 Orbafoam Fire Stop B1
- 58 Orbafoam Pro Tiles
- 59 Orbafoam Xtrem

### Multi-purpose PU Foams

- 61 Orbafoam Multi-purpose
- 61 Hauser Basic & Hauser Pro

### Accessories

- 62 Orbafoam Fresh Foam Cleaner
- 62 Orbafoam Dry Foam Remover
- 62 PU Foam Straws

### Guns

- 63 Economic Gun
- 63 Caliber 30 Gun
- 63 Pro Graphite Gun

Polyurethane foam

# ORBAFOAM PRO 45

High performance



High-performance polyurethane foam

Certified for acoustic insulation  
62db – straw and 63db - gun

Excellent properties in adherence,  
sealing and filling

Highly compact and homogeneous cells

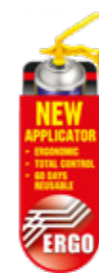

## Orbafoam Pro 45 / Pro 25 / Pro 15

High-quality professional polyurethane foam with expansion up to 45 litres / 25 litres / 15 litres respectively.

**Applications:**

- ORBAFOAM quality. Excellent properties of adherence, sealing and filling.
- More compact and homogeneous cells. It provides excellent thermal and acoustic insulation.
- Certified acoustic insulation up to 62dB - straw and 63dB - gun.
- Ideal for construction works and decoration in general, such as installing doors and windows, filling and sealing all types of cracks and holes.

**Advantages:**

- ERGO straw: Reusable along 60 days & total ergonomic control.
- Superior yield (+20%).
- New valve: greater resistance to blockage.
- Shelf life: 18 months.

Packaging	Content	Colour	Code	EAN13 barcode No.	Units/box
Aerosol for straw	300ml	Yellow	10039902	8411729331597	12
	500ml	Yellow	10039901	8411729330279	12
	750 ml	Yellow	10026675	8411729111229	12
Aerosol for gun	750 ml	Yellow	10025046	8411729114039	12



Product video



## Professional PU Foams



EI 240



M1

CTE

CIDEMCO



M1



## Professional PU Foams



RE-USABLE  
9 ALONG MONTHS



M1



Product video

### Orbafoam Fire Stop B1

B1 polyurethane foam for passive fire protection.

**Applications:**

- For sealing, insulating and filling joints, cracks and holes around frames of windows, doors, sliding screens, joints between buildings, wall joints, firewalls... wherever fire protection is required.

**Advantages:**

- It provides resistance and insulation to fire up to 4h according to the standard UNE EN 1366-4 / 13501-2.
- It is smoke and gas-proof.
- Thermal and acoustic insulation.
- Shelf life: 12 months.

### Orbafoam Pro Tiles

Polyurethane adhesive foam for bonding and installing tiles.

**Applications:**

- For bonding all types of tiles (flat, mixed, Arabic) to concrete, mortar, wood or fiber-cement. It provides strong, durable adherence to most construction materials, substituting mortars, reducing working times and costs. Easily and quickly.
- Tests carried out by cidemco guarantee our product and certify it for installing tiles.
- Product resistant to temperature cycle changes without ageing.

**Advantages:**

- Strong, lasting adherence
- Controlled expansion.
- Product resistant to temperature changes without ageing.
- Resists winds and turbulence up to 110 km/h.
- No loss of adherence due to ageing.
- Shelf life: 18 months.

### Orbafoam Xtrem

High-quality, professional polyurethane foam. 360° multi-position and 9 months re-usable.

**Applications:**

- Ideal for bonding, sealing and filling all types of surfaces.
- Due to its valve it is ideal for carrying out works where low product quantities are repeatedly applied over time (up to 9 months after first use).
- Multi-position 360°C valve to allow its application in hard to reach places.

**Advantages:**

- RE-USABLE up to 9 months after first use.
- 360° MULTI-POSITION.
- B2 Fire Stop Classification: Self-extinguishing, it does not spread fire (DIN4102).
- Its anti-blockage valve facilitates storage and transport by permitting flat placing.
- Shelf life: 18 months.

Packaging	Content	Colour	Code	EAN13 barcode No.	Units/box
Aerosol for straw	750 ml	Yellow	10025048	8411729052232	12

Packaging	Content	Colour	Code	EAN13 barcode No.	Units/box
Aerosol for straw	750 ml	Grey	10036223	8411729408169	12
Aerosol for gun	750 ml	Grey	10003282	8411729384067	12

Packaging	Content	Colour	Code	EAN13 barcode No.	Units/box
Aerosol for straw	750 ml	Grey	10038238	8411729327897	12
		Red	10038311	8411729404109	12
Aerosol for gun	750 ml	Grey	10024978	8411729251222	12
		Red	10024976	8411729401627	12



Product video

## PROFESSIONAL PU FOAMS

### Comparative Table

	ORBAFOAM	Applicateur	Advantage	Performance	Re-usable	Controlled Expansion	Acoustic Insulation	Fire Classification
General Use	Xtrem	straw	Re-usable Multi-position	40L	High	No	No	B2
	PRO 45	straw	High Performance Acoustic Certified	45L	Medium	No	62 db	B3
gun		45L		Medium	Medium	63 db	B3	
Windows and Doors	PRO Energy Controlled Expansion	gun	60% Energy Saving	45L	Medium	High	64 db	B3
	Control Expansion	gun	Superior Yield	55L	Medium	High	60 db	B3
Tile Installation	Tiles	straw	Cidemco Certified	45L	Medium	No	No	B3
		gun	Against strong winds	45L	Medium	Medium	No	B3
Fire Protection	Fire Stop	straw / gun	Resistance FR / EI240	40L	No	No	No	B1

# ORBAFOAM MULTI-PURPOSE

NUMBER 1 SELLING MULTI-PURPOSE  
POLYURETHANE FOAM



## Orbafoam Multi-Purpose

Nr. 1 selling multi-purpose polyurethane foam, for application with straw or gun.

**Applications:**

- Excellent sealing, adherence and filling properties.
- High adherence to most construction materials.
- Thermal and acoustic insulation.

**Advantages:**

- O2: 0% harmful MDI emissions during foam application.
- M1: no emissions of harmful substances once cured. M1 emissions classification for products.
- Excellent quality, compact and homogeneous cells.

## Hauser Basic & Hauser Pro

General-use polyurethane foam for application by manual straw or gun.

**Applications:**

- Polyurethane foam for filling, insulating and assembling.

**Advantages:**

- Fast curing and medium expansion.

Packaging	Content	Colour	Code	EAN13 barcode No.	Units/box
Aerosol for straw	750ml	Yellow	10041204	8411729489182	12
Aerosol for gun	750ml	Yellow	10041205	8411729417499	12

Packaging	Content	Colour	Code	EAN13 barcode No.	Units/box
Aerosol for straw	750ml	Yellow	10024386	8411729281820	12
	500ml	Yellow	10025126	8411729162955	12
Aerosol for gun	750ml	Yellow	10024388	8411729381745	12

Excellent quality.

Highly compact cells.

Excellent adherence to  
all materials.

Thermal and acoustic  
insulation.



Safe Application



No MDI emissions



## Orbafoam Cleaner

### Fresh Foam

Cleaner for fresh polyurethane foam.

#### Applications:

- Cleaner of recently-applied polyurethane foam. Ideal for cleaning and conserving surfaces as well as polyurethane foam guns.
- Can be used with gun or spray.

#### Advantages:

- Eliminates fresh foam, leaving no residue.

## Orbafoam Remover

### Dry Foam

Removes cured polyurethane foam.

#### Applications:

- Cleans and removes the remains of cured PU foam from surfaces as varied as aluminum and PVC, glass, ceramic... without damaging the cleaned surfaces.
- It only dissolves cured foam leaving the other surfaces intact.
- Excellent cleaner of paints and sealants residues.

#### Avantages:

- ULTRA-RAPID. The product dissolves foam in 1-2 minutes making it extremely easy to remove with a mop or similar.
- SAFE TO USE: The product has a pleasant smell and does not irritate the skin.
- EASY TO USE: The packaging comes in form of an easy to use spray.

## Straw PU Foam

Replacement straws for aerosol foams of manual use.

## Gun Foam Economic

Universal gun for applying polyurethane foam.

#### Advantages:

- Excellent price-quality relationship.
- Light, ergonomic, easy-to-use, safe handle.
- Innovative closure to prevent wasting foam.

## Gun Foam Caliber 30

Professional gun for applying polyurethane foam.

#### Advantages:

- Keeps foam thickness stable during the application process. Light, ergonomic, easy-to-use, safe handle. Innovative closure to prevent wasting foam.
- Increases foam yield up to 30%.

## Orbafoam Gun Pro Graphite

Excellent-quality, long-lasting aluminium gun with non-stick teflon coating.

#### Advantages:

- Keeps foam thickness stable during the application process. Light, ergonomic, easy-to-use, safe handle. Innovative closure to prevent wasting foam.
- Aluminium body with a non-stick teflon coating
- Equipment: 2 caps for the nozzle, 2 tubes, 1 scraper

Packaging	Content	Colour	Code	EAN13 barcode No.	Units/box
Cartridge	500 ml	Colourless	10025032	8411729736507	12

Packaging	Content	Colour	Code	EAN13 barcode No.	Units/box
Blister	100ml	Colourless	10044090	8411729220129	8

Packaging	Content	Code	EAN13 barcode No.	Units/box
Bag	5 u.	10042682	8411729136314	6

Packaging	Content	Code	EAN13 barcode No.	Units/box
Unit	Unit	10036216	8411729266257	1

Packaging	Content	Code	EAN13 barcode No.	Units/box
Unit	Unit	10003731	8411729041434	1

Packaging	Content	Code	EAN13 barcode No.	Units/box
Unit	Unit	10040043	8411729736439	1



# ORBAFOAM FIXATION 60 SEC

Adhesive Foam

**60 seg** Initial tack in 60 seconds



**500 kg/dm<sup>2</sup>** EXTREM 500kg/dm<sup>2</sup>



## ORBAFOAM FIXATION 60 SEC

First adhesive with high initial tack and immediate bonding presented in foam format. The innovative TYTACK technology revolutionizes traditional bonding systems.

**Applications:**

- Ideal for bonding all types of insulating panels, eps/xps panels, plaster panels, wood, conglomerate, porexpan boards, decorative elements, ceiling / wall repairs and insulation, fix windowsills, stairs and baseboards, calibrated blocks, as well as assembling of door frames, skirting, tiles, bathroom pieces, stone, rubber, metal, plastics (except PE, PP and PTFE).

**Advantages:**

- IMMEDIATE initial adhesion: in 60 seconds.
- Perfect adherence even on vertical surfaces.

- EXTREME STRENGTH: Maximum Resistance 500kg/dm<sup>2</sup>
- MEGA EFFICIENCY: One aerosol performs 40 lineal meters, does the same work than 25kg of traditional mortar or 6 cartridges of assembly adhesives. Cheaper than to use 6 cartridges of assembly adhesives too.
- CONTROLLED EXPANSION: Does not expand nor distort the bonded surfaces, does not deform material.
- READY FOR USE: Saves time and money, does not require electricity, water, or any extra primer.
- BONDS WHEN WET: May be applied on wet surfaces without losing adherence or bonding speed.
- ALL TYPES OF MATERIALS: May be used both for porous and non-porous materials. Indoor and outdoor use.

**IMMEDIATE grab**

**Extreme resistance, up to 500 Kg/dm<sup>2</sup>**

**Does not expand nor distort bonded surface areas. Does not deform material.**

Packaging	Content	Colour	Code	EAN13 No. 2020	Units/box
Aerosol for straw	300 ml	Yellow	10041077	8411729202309	12
	750 ml	Yellow	10041079	8411729202224	12
Aerosol for gun	750 ml	Yellow	10040750	8411729191177	12



Product video

# ORBAFOAM FIXATION PLAQUE

For installing gypsum plasterboards and decorative panels

Easy leveling.

Up to 2cm. of correction margin.

Immediate grip

Very high yield



Works faster.  
Work better.

**IMMEDIATE** initial grip

Extreme adhesive power:  
Up to 500 Kg/dm<sup>2</sup>.

It neither expands nor  
distort the mounted  
surfaces. It does not  
misshape materials.



## FIXATION BOARDS

New Adhesive technology with high initial tack and immediate bonding presented in foam format. The innovative 3D Control technology revolutionizes traditional bonding systems.

### Applications:

- Quilosa Professional Foam Adhesive for Gypsum Cardboard is a ready-to-use solution recommended for bonding boards, such as gypsum based fiberboards/cardboards and cementitious boards as a finishing layer on existing surfaces, such as walls and columns.

### Advantages:

- 3 dimensions board levelling: Adjust the board vertically, horizontally and also its depth creating a seamless wall.
- CONTROLLED EXPANSION: Does not expand nor distort the bonded materials.
- Indoor and outdoor use
- No post-expansion: After final adjustment the board will not change position, next board can be bonded without the need for secondary adjustment.
- Up to 2 cm correction of walls unevenness: High density of the formula allows correction of unevenness of the wall up to 20 mm, making its application possible even in uneven walls.
- Immediate board grab: Product can be bonded to the substrate, immediately after the application. Apply, Bond, Adjust and you are done.

Packaging	Content	Colour	Index Code	EAN13 No. 2020	Units/box
Aerosol for gun	750 ml	Blue	10041627	8411729440404	12



## ORBAFOAM ETICS

High-performance adhesive foam suitable for the assembly of ETICS panels. The formula's density ensures very high initial tack, achieving strong adherence.

**Certification EOTA: ETAG 004 / technical report nr. 46 ETA-16/0161**

### Applications:

- Its use is ideal for the assembly of expanded polystyrene (EPS), extruded polystyrene (XPS), polyurethane (PUR) panels, mineral wool and glass foam. It can be applied on most construction materials: concrete, wood, bituminous membranes, ceramic, glass, metal, PVC.

### Advantages:

- Immediate bonding.
- Allows corrections
- Maximum efficiency.
- Express installation: Mechanical bonding in 2 h.
- Excellent adherence in EPS Graphite.

## ADHESIVE FOAMS

### Comparative Table

TECHNICAL DATA	60 SEC	ETICS	FIXATION BOARDS
Colour	yellow	grey	blue
Application temperature	+5°C to +35°C	0°C to +30°C	+5°C to +30°C
Can temperature	+5°C to +35°C	+10°C to +30°C	+10°C to +30°C
Maximum open sticking time	≤ 2 min	< 5 mins	≤ 2 min
Correction time	< 3 min	< 10 mins	< 5 min
Next process		after 2h	30 min
Yield	Up to 40 m	up to 10 m <sup>2</sup>	Up to 10 m <sup>2</sup> (up to 3 GC boards)

Packaging	Content	Colour	Code	EAN13 barcode No.	Units/ box
Aerosol for gun	750 ml	Grey	10040333	8411729083267	12

## ADHESIVES



Adhesives in Quilosa, since its creation in 1940 until today, have been one of the company's priorities. The intrinsic quality in each of our products has allowed us to develop one of the most professional and extensive ranges of adhesives for both professional and DIY uses. The most advanced technology in Assembly Adhesives, Contact Adhesives, White Glues, Instant Adhesives, PVC... and other specialities.

Adhesive Fixation MS  
 73 Power Fix Instant Strong  
 74 Power Fix Flex  
 74 Power Fix High Tack  
 75 Power Fix Instant Invisible

Assembly Adhesives  
 77 Fix Express  
 77 Fix Forte  
 77 Fix Invisible  
 78 Fix PU Xtrem  
 78 Multifix PU liquid

White Glues  
 80 Unifix M-80  
 80 Unifix Floors  
 81 Unifix Rapid  
 81 Unifix M-54 General Use

Contact Adhesives  
 82 Bunitex P-55 - General Use  
 82 Bunitex P-29

PVC Adhesives  
 85 Sintex H-44 PVC-U  
 85 Sintex PVC-U Adhesive  
 85 Sintex PVC Cleaner

Instant Adhesives  
 86 Instant Fix  
 86 Fix CA-24  
 86 Fix CA-30 + Accelerator

Special Adhesives  
 87 Sintex H-26

# POWERFIX

Adhesives Fixation MS



## EVERYTHING WITH EVERYTHING

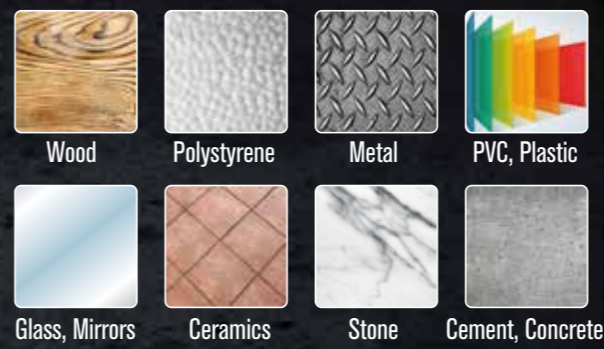

## PowerFix Instant Strong

**FAST WORK.** Immediate fixation and fast curing. For all types of materials including heavy ones.

**Applications:**

- Fixation of elements where a immediate resistant and flexible bonding is required.
- ALL TYPE OF APPLICATIONS: Panels, skirting boards, door frames, sanitary accessories, metal and plastic parts, sheets, mirrors, insulation boards, prefabricated elements, chipboard panels, industrial bodywork...
- MULTIMATERIALS: Brick, metal, marble, stone, wood, ceramics, polystyrene, PVC, HDF, MDF, mirrors, glass, cork and others. NOTE: Do not use for PE, PP, Teflon and bituminous substrates.

**Advantages:**

- The adhesion is so strong that it can be subjected to loads after 20-30 min, depending on the substrate and external conditions.
- Resistance to the hardest conditions: Thermal resistance -40°C to + 90°C and UV radiation.
- Indoor and outdoor use.
- Adheres even on damp surfaces.

All Materials **Interior Exterior** Glued even on wet surfaces **Flexible** Immediate Grip **Extreme Force** No Shrinkage **Filling Power** Without Solvents Antimould Resistance **UV Rays** Paintable **Odourless** Excellent **Durability** Non-Corrosive Resistance **Maximum Elongation**

**The Superpower to Fix Everything**

Packaging	Content	Code	Colour	EAN13 No. 2020	Units/box
Cartridge	290ml	10041621	White	8411729391072	6
		10041646	Brown	8411729334154	6
		10041647	Black	8411729333812	6
		10041641	Grey	8411729400064	6
		10041645	Cream	8411729333997	6

\*Please reach out to our Customer Support team at [atncliente@selena.com](mailto:atncliente@selena.com) for the launch date of the 2021 Codes



## PowerFix Flex

FIXES, SEALS and REPAIRS all types of materials.

### Applications:

- MULTIMATERIALS: Brick, metal, marble, stone, wood, ceramics, polystyrene, polycarbonate, aluminium, PVC, DM, MDF, mirrors, glass, cork and others. NOTE: do not use on PE, PP, Teflon or bituminous substrates.

### Advantages:

- ELASTIC: Excellent durability that extraordinarily cushions vibrations, expansion and contraction movements.
- Adhesion of a polyurethane+ Elasticity of a silicone
- Resistance to the hardest conditions: Thermal resistance -40°C to + 90°C and UV radiation.
- Indoor and outdoor use.
- Adheres even on damp surfaces.

## PowerFix High Tack

INSTANT GRAB OF HEAVY PARTS. INSTANT FIXING of all types of materials. ELASTIC: Absorbs vibrations and expansion and contraction movements.

### Applications:

- MULTIMATERIALS: Brick, metal, marble, stone, wood, ceramics, polystyrene, polycarbonate, aluminium, PVC, DM, MDF, mirrors, glass, cork and others. NOTE: Do not use for PE, PP, Teflon and bituminous substrates.

### Advantages:

- ELASTIC: Excellent durability that extraordinarily cushions vibrations, expansion and contraction movements.
- Resistance to the hardest conditions: Thermal resistance -40°C to + 90°C and UV radiation.
- Indoor and outdoor use.
- Adheres even on damp surfaces.

## PowerFix Instant Invisible

Ideal for works where INVISIBLE, CLEAN and AESTHETIC finishes are required. FIXES, SEALS and REPAIRS all types of materials.

### Applications:

- MULTIMATERIALS: Brick, metal, marble, stone, wood, ceramics, polystyrene, PVC, HDF, MDF, mirrors, glass, cork and others. NOTE: Do not use for PE, PP, Teflon and bituminous substrates.

### Advantages:

- ELASTIC: Excellent durability that extraordinarily cushions vibrations, expansion and contraction movements.
- TRANSPARENT: clean and invisible finishes.
- Resistance to the hardest conditions: Thermal resistance -40°C to + 90°C and UV radiation.
- Indoor and outdoor use.
- Adheres even on damp surfaces.

## ADHESIVE FIXATION MS Comparative Table

PRODUCT	SEALED	TACK	CURED	STRENGTH
<b>FLEX</b>	++++	++	++	+++
<b>INSTANT STRONG</b>	+++	++++	++++	++++
<b>INSTANT INVISIBLE</b>	+++	+++	+++	+++
<b>INSTANT HIGH TACK</b>	++	++++	++	+++

Packaging	Content	Code	Colour	EAN13 No. 2020	Units/box
Cartridge	290ml	10043213	White	8411729333652	12

Packaging	Content	Code	Colour	EAN13 No. 2020	Units/box
Cartridge	290ml	10041589	White	8411729334314	12

Packaging	Content	Code	Colour	EAN13 No. 2020	Units/box
Cartridge	290ml	10041739	Transparent	8411729390655	12

# FIX INVISIBLE

Transparent Assembly



Long-lasting, clean and fast results.

Ultra resistant.

Indoor and outdoor use.

Excellent results bonding with plastics, methacrylate, wood, ceramic, plaster or metals.



## Fix Express

Solvent-free assembly adhesive, with immediate grab.

### Applications:

- Bonding of decoration and construction elements.
- Bonding of frames, skirting, panels, tiles, plaster.
- Suitable for bonding expanded polystyrene, insulation materials, wood, gypsum, bricks, etc
- At least one of the materials to be bonded must be porous.

### Advantages:

- Immediate grab.
- Multi-materials.
- Solvent-free, odourless.
- Washable with water.
- Indoor and outdoor use.
- Great filling capacity.
- Direct bonding.
- Resistance: 120 kg/cm<sup>2</sup>

## Fix Forte

Solvent-based, extra-strong assembly adhesive.

### Applications:

- Bonding of construction materials.
- Bonding of cable ducts, frames, slats, skirting board, insulation, signs indicators, bathroom and kitchen accessories, lighting points, alarms.
- Suitable for bonding plastic, wood, ceramic, plaster or metal on cement, concrete, mortar.

### Advantages:

- Extra-strong bonding.
- Indoor and outdoor use.
- Suitable for porous and non-porous materials.
- Flexible bonding.
- Direct bonding.
- Resistance: 300 kg/10cm<sup>2</sup>

## Fix Invisible

Transparent assembly adhesive for invisible, lasting joints.

### Applications:

- Bonding of decoration and construction materials.
- Bonding and assembly on all types of surfaces.
- Suitable in applications with transparent materials.
- Bonding of cable ducts, frames, slats, skirting board, insulation, signs indicators, bathroom and kitchen accessories, lighting points, alarms.
- Suitable for bonding plastic, wood, ceramic, plaster or metal on cement, concrete, mortar.

### Advantages:

- Invisible bonding.
- Lasting, clean, and fast results.
- Indoor and outdoor use.
- Suitable for porous and non-porous materials.
- Flexible and resistant joints.
- Direct bonding.
- Resistance: 200 kg/10cm<sup>2</sup>

Packaging	Content	Colour	Code	EAN13 barcode No.	Units/box
Cartridge	375 gr	White	10024498	8411729189372	12
Tube	250 gr	White	10043587	8411729452940	12

Packaging	Content	Colour	Code	EAN13 barcode No.	Units/box
Cartridge	350 gr	Beige	10043091	8411729451202	12
Tube	100 gr	Beige	10042993	8411729228972	12

Packaging	Content	Colour	Code	EAN13 barcode No.	Units/box
Cartridge	300 ml	Transparent	10025094	8411729451387	12

( D4 moisture resistance (UN-EN204) )



( D4 moisture resistance (UN-EN204) )



### Fix PU Xtrem

Thixotropic polyurethane adhesive, resistant to humidity and water.

**Applications:**

- Bonding of indoor and outdoor wooden structures.
- Naval construction.
- Suitable for joinery and furniture assembly.
- Suitable for bonding wood or in combination with concrete, mortar, ceramic, stone or metal.

**Advantages:**

- **Resistant to the humidity and water even being sea water, according to UNE-EN 204.**
- Bonds even on wet surfaces.
- Indoor and outdoor use.
- Great filling capacity.
- Sandable.
- Paintable.
- Solvent-free.
- Extra-resistant joints.
- Resistance: 1000 kg/10cm<sup>2</sup>

### Multifix PU Liquide

Solvent-free, water-resistant, single-component, liquid polyurethane adhesive.

**Applications:**

- Ideal for carpentry and furniture assembly.
- Ideal for boats.
- Highly recommended for constructions in wood and unions that must withstand weathering.
- Suitable for application on tropical wood.

**Advantages:**

- Quickly reaches high resistance values.
- **Great resistance to the humidity and water, even being sea water, according to UNE-EN 204.**

## ASSEMBLY ADHESIVES

### Comparative Table

	FIX PU XTREM	FIX INVISIBLE	FIX FORTE	FIX EXPRESS
<b>Main Advantage</b>	Bonds on wet surfaces D4	Transparent	Superior strenght	Immediate grab
<b>Bond strength</b>	1000 kg/10 cm <sup>2</sup>	200 kg/10 cm <sup>2</sup>	300 kg/10 cm <sup>2</sup>	120 kg/10 cm <sup>2</sup>
<b>Technology</b>	Polyurethane	Solvent-based	Solvent-based	Water-based
<b>Wood</b>	High	High	High	High
<b>Expanded Polystireneo</b>	High	No	No	High
<b>Metal</b>	High	High	High	Medium
<b>Tiles</b>	Medium	Medium	High	Medium
<b>Glass</b>	Medium	High	Medium	Medium
<b>Rigid PVC</b>	High	High	High	Medium
<b>Ceramic</b>	Medium	High	High	Medium
<b>Natural Stone</b>	Medium	No	No	Medium
<b>Marble</b>	Medium	No	No	Medium



Packaging	Content	Colour	Code	EAN13 barcode No.	Units/ box
Cartridge	445 gr	Beige	10043109	8411729285067	12
	340 gr	Translucide	10042778	8411729170462	12

Packaging	Content	Code	EAN13 barcode No.	Units/ box
Bottle	850 gr	10043108	8411729284800	12





## Unifix Rapid

Rapid-bonding white glue for wood.

### Applications:

- Suitable for bonding all types of wooden furniture and gluing agglomerates, laminates, cardboard, paper and modelling pieces.

### Advantages:

- **Moisture resistant D3.**
- Rapid bonding.
- Resistant, lasting joints.
- Transparent once dry.

## Unifix M-54

White glue for joinery and DIY work.

### Applications:

- Mounting and assembly works.
- Suitable for bonding wood, cork, paper, wooden agglomerate, cardboard and decoration.

### Advantages:

- Strong, resistant joints.

## BUNITEX P-55

Long open time.

### Applications:

- Bonding of rubber, leather, wood, cork, formica, metal, plastics, synthetic fibres, ceramic, cardboard, etc.
- Bonding of wood, shoes, rubber seal linings, waterproofing sheets such as canvas pool covers, melamine, decorative laminates, green house plastics.
- Recommendable for bonding large surface areas.

### Advantages:

- Resistant, lasting, flexible joints.
- Long open time.

## BUNITEX P-29

High performance: Rapid adherence.

### Applications:

- Bonding and repairs of rubber, leather, wood, cork, formica, metal, plastics, synthetic and plant fibres, ceramic, cardboard, etc.
- For repair and DIY work.

### Advantages:

- Strong initial tack.
- Flexible, lasting joints.
- High resistance

Packaging	Content	Code	EAN13 barcode No.	Units/box
Bottle	100 gr	10043825	8411729712419	24
	250 gr	10043877	8411729882112	12
	500 gr	10043869	8411729880057	12
Jerrican	5 kg	10043244	8411729349264	1
	26 kg	10042521	8411729090920	1

Packaging	Content	Colour	Code	EAN13 barcode No.	Units/box
Pail	250 gr	White	10042408	8411729060312	24
	500 gr	White	10042409	8411729060497	16
	1 kg	White	10042410	8411729060565	12
	6 kg	White	10042411	8411729060640	1
Jerrican	12 kg	White	10042412	8411729060725	1
	26 kg	White	10042431	841172906437	1

Packaging	Content	Code	EAN13 barcode No.	Units/box
Can	250 ml	10043191	8411729326807	18
	500 ml	10043189	8411729326647	16
	1 l	10043190	8411729326722	12
	5 l	10043192	8411729326982	2
Drum	24 l	10042237	8411729020897	1

Packaging	Content	Code	EAN13 barcode No.	Units/box
Tube w/ Blister	50 ml	10042698	8411729141004	12
Tube in Dispenser	175 ml	10043188	8411729326494	12
Drum	5 l	10042178	8411729000677	2



## CONTACT GLUE SPRAY ADHESIVE

Permanent & Repositionable

Spray contact adhesive for general use.

### Applications:

- Ideal for gluing metal, wood, leather, rubber, glass, cardboard, cork, plastics, flexible PVC, methacrylate, laminates, rigid PVC and textiles.

### Advantages:

- Colorless, does not stain or wrinkle materials.
- Repositionable: Maintains stickiness for a very long time.



## BUNITEX

Transparent

Maximum bonding resistance. Invisible.

### Applications:

- Bonding of flexible PVC, textile, canvases, rubber, cork, leather, paper, etc.
- For invisible joints in DIY and repair work.
- Suitable for repairing awnings, canvases, tents, etc.

### Advantages:

- Invisible bonding.
- Strong initial tack.
- Flexible, lasting joints.
- High resistance.

Packaging	Content	Colour	Code	EAN13 barcode No.	Units/box
Spray	400 ml	Transparent	10041770	8411729444539	6

Packaging	Content	Colour	Code	EAN13 barcode No.	Units/box
Tube w/ Blister	50 ml	Transparent	10043245	8411729350482	12

# SINTEX PVC-U

Adhesive for PVC tubes

For all types of applications

Complies with UNE 14814 PVC-U / PN 16

Allows joining tubes with clearances of up to 0.6 mm

Successfully tested for 1.000 hours at 51 bar pressure = 520m water column

- For rigid and flexible PVC
- Resists up to 16 bars PN
- With brush
- Shelf life 24 months



## SINTEX H-44 PVC-U

Adhesive for bonding rigid and flexible PVC tubes.

**Aplicaciones:**

- Special for bonding PVC tubes in plumbing, pools, irrigation and repairs.

**Advantages:**

- Universal, valid for high and low pressure and for rigid and flexible PVC.
- It resists up to 16 bars nominal pressure.

## Sintex PVC-U

Welding adhesive for rapid, resistant and lasting joints of tubes, slabs and rigid or flexible PVC accessories in pressure systems. **Compliant with standard UNE-EN 14814 PVC-U / PN16.**

**Aplicaciones:**

- All types of applications: sanitation, pools, irrigation and repairs and professional installations in general.
- Resists up to 16 bars of nominal pressure successfully passing a test from 1,000 h to 51 bars of pressure, (equivalent to a water column of 520 m).
- Bonds tubes with a clearance of up to 0.6 mm..

**Advantages:**

- Adhesive for rigid and flexible PVC tubes.
- Rapid drying.
- Longer shelf life, up to 24 months

## Sintex PVC Cleaner

Solvent cleaner for use with Sintex PVC-U adhesive.

**Aplicaciones:**

- Cleaning and degreasing surfaces before bonding pipes or hoses.
- Cleaning of paintbrushes and utensils used in bonding.

**Advantages:**

- Facilitates gluing and ensures optimal bonding to PVC.

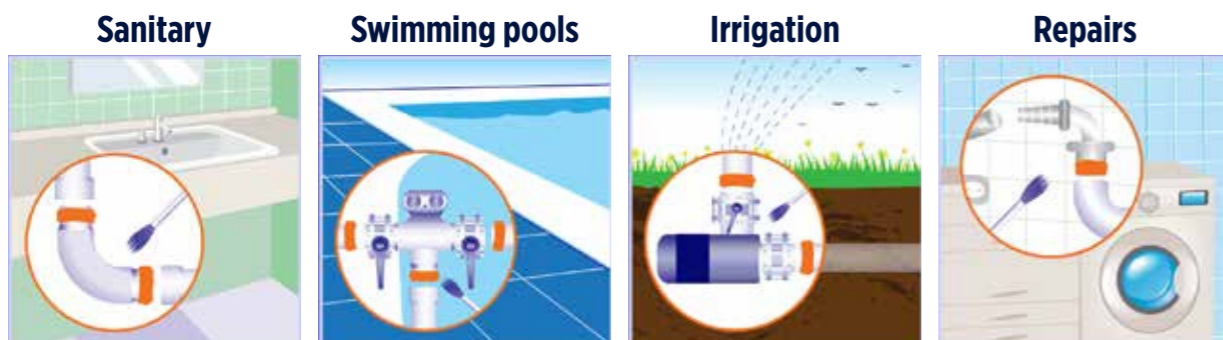

Packaging	Content	Code	EAN13 barcode No.	Units/box
Can with brush	1 l	10042560	8411729099510	12 *E

Packaging	Content	Code	EAN13 barcode No.	Units/box
Tube Dispenser	125 ml	10043677	8411729471422	12
Can with brush	250 ml	10042737	8411729158262	12
	500 ml	10042738	8411729158347	12
	1 l	10042739	8411729158422	12

Packaging	Content	Code	EAN13 barcode No.	Units/box
Can	500 ml	10042740	8411729158590	16

\*E Reference on request from factory. Consult stocks and delivery points.



### INSTANT FIX

Cyanoacrylate adhesives for home use.

**Applications:**

- Bonding and repair of multiple materials.

**Advantages:**

- Instant bonding.
- High resistance.
- Colourless

### FIX CA-24

Low-viscosity, transparent cyanoacrylate adhesive for bonding rubber, metal pieces and plastic.

**Advantages:**

- Bonds materials in seconds, so it is ideal for quick repairs.
- No additional bonding mediums required.
- Immediate mechanization.
- Solvent-free.

### KIT FIX CA-30 + Accelerator

Cyanoacrylate adhesive and accelerator spray for wood.

**Applications:**

- Bonds all types of materials, especially porous such as wood or agglomerate.
- Bonds wooden pieces such as finishing in kitchens and wooden furniture: friezes, crests, miter joints, etc.

**Advantages:**

- Application of the accelerator spray before the CA-30 adhesive provides good bonding results preventing the adhesive to enter into very porous materials such as wood.
- Rapid joints.
- Invisible.
- High resistance.

### SINTEX H-26

Expanded Polystyrene

Special adhesive for expanded polystyrene.

**Applications:**

- Bonding and assembly of insulation panels and decoration pieces of expanded polystyrene.

**Advantages:**

- Maximum adherence.
- Does not damage porexpan.
- Strong, lasting unions.

Packaging	Content	Colour	Code	EAN13 barcode No.	Units/box
Bottle Blister	8 gr	Transparent	10042946	8411729214692	12
Tube Blister	3gr	Transparent	10042945	8411729214517	24

Packaging	Content	Colour	Code	EAN13 barcode No.	Units/box
Bottle	20 gr	Transparent	10043059	8411729254117	12

Packaging	Content	Colour	Code	EAN13 barcode No.	Units/box
Bottle + Aerosol	50 gr + 150 ml	Transparent	10043052	8411729250317	6

Packaging	Content	Code	EAN13 barcode No.	Units/box
Can	1 l	10043810	8411729651770	12
Bidon	5 l	10043811	8411729651855	2

## ADHESIVE TAPES



- Adhesive Tapes
- 90 Double-Sided Tape
  - 90 Double-Sided Tape with Fibers
  - 91 Masking Tape
  - 91 Duct Tape

Quilosa offers a wide range of adhesive tapes providing solutions to any home need. High quality and easy use, guaranteeing a definitive solution.



## Double-Sided Tape with Fibers

Double-sided tape with fibers, with high initial tack and bonding strength.

### Applications:

- Perfect for applications supporting majors load.
- Smooth and rough surfaces.
- Easy, instant assembly on all types of objects (e.g., panels, hooks, alarm systems).

### Advantages:

- Excellent internal resistance and superior bonding power.
- Ultra-high final adherence to different surfaces.
- The polyester mesh provides extreme resistance and allows the product to be torn by hand.

Packaging	Content	Colour	Code	EAN13 barcode No.	Units/box
Blister	19 mm x 2,5 m	Blue	10034028	8411729212957	12



## Masking Tapes

High-quality masking tapes, with thickness of 110 microns, of crepe paper coated with silicone oil on one side and acrylic water-based adhesive on the other.

### Applications:

- Surfaces protection for applications of spray, paint, lacquer and plaster.
- Chassis of automobiles during painting (if intended to dry in a heat chamber, a special heat-resistant tape should be used).
- Protection of metal, plastic and glass surfaces against scratches
- Lining of sharp borders to increase safety.
- Mounting of small electrical components (such as transistors) bonding them to the tape.
- Protection of mirrors borders and glasses to avoid scratch risk.

### Advantages:

- Good adaptability.
- Does not leave adhesive residue.
- Smooth edges.
- Strong grip.
- Retraction ability.

Packaging	Content	Colour	Code	EAN13 barcode No.	Units/box
Roll	18 mm x 45 m	Ecru	10036316	8411729211547	52
	24 mm x 45 m	Ecru	10036315	8411729211622	40
	29 mm x 45 m	Ecru	10036314	8411729211707	32
	36 mm x 45 m	Ecru	10036313	8411729212049	28
	48 mm x 45 m	Ecru	10036312	8411729212124	20



## Duct Tape

High-resistance duck adhesive tape with reinforcement mesh.

### Applications:

- For repairing, sealing, bonding and insulating. It bonds to rubber, leather, wood, metal, plastic, canvas, etc.
- It is a very useful product in DIY work and for all types of home repairs.

### Advantages:

- It consists of 3 layers: polyethylene (impermeable), polyester (resistant) and elastomer (adherent). It withstands temperatures from -5°C up to 70°C. It has high resistance to traction: up to 15 kg per turn.
- High resistance and major adhesion strength to all surfaces.
- With fibers that give greater resistance to traction.

Packaging	Content	Colour	Code	EAN13 barcode No.	Units/box
Roll	50 mm x 10 m	Grey	10042722	8411729152062	12
	50 mm x 10 m	Black	10042938	8411729212209	12
	50 mm x 25 m	Grey	10042939	8411729212469	6
	50 mm x 25 m	Black	10042940	8411729212537	6
	50 mm x 50 m	Grey	10042941	8411729212612	6
	50 mm x 50 m	Black	10042942	8411729212797	6

## CHEMICAL ANCHORS



### Chemical Anchorage

- 94 Injection sleeves for chemical anchors
- 94 Mixing nozzles for chemical anchors
- 94 Difficult extrusion product gun
- 94 410 ML chemical anchor gun
- 94 EV1 Styrene-free polyester chemical anchor
- 95 EV2 Epoxy chemical anchor
- 95 EV3 Epoxy Acrilate chemical anchor

### MAXIMUM RELIABILITY FOR PROFESSIONAL FIXATIONS

In a large majority of current construction systems, there is a need for providing anchorage and bonding with maximum benefits. Many of these fixations have a structural function, which requires the use of certified products.

Quilosa offers a full range of chemical anchorages adapted to the needs of professionals in construction.

In stone, concrete, brick, masonry or cement, in each material and in each application, QUILOSA's chemical anchorage will always provide maximum resistance and safety.



Chemical Anchors

Chemical Anchors



Injection sleeves



Mixing Nozzles



**Injection Sleeves**

Injection sleeves of 15 x 85 mm for anchors on hollow surfaces.

**Applications:**

- Application on hollow materials such as bricks or concrete blocks.

**Advantages:**

- Facilitates the correct distribution of the anchor in the hole to be filled.

**Mixing Nozzles**

Mixer for two-component chemical anchor resins.

**Advantages:**

- Allows faster mixing.
- Reduces waste of the product initially mixed,
- Facilitates application, with very little resistance to extrusion.

**Gun for Difficult Extrusion Products**

High-quality gun, facilitates extrusion both for cartridges of chemical anchors and other products till 310 ml cartridges.

**Advantages:**

- Resistant structure.
- Ideal for intensive use in construction.

**410 ml Chemical Anchor Gun**

Easy-to-use gun for chemical anchor cartridges up to 380 ml.

**Advantages:**

- Rigid structure.
- Designed for application of viscous products, facilitates extrusion.

**EV1 Chemical Anchor**  
Styrene-Free Polyester

The EV1 chemical anchor is a rapid-curing two-component resins for fixations in solid construction supports or hollow materials, in walls, columns, facades, floors, etc.

**Applications:**

- Bonding of doors, frames and metal fastenings.
- Positioning of awnings and marquees.
- Installation of toilets and bathroom fittings in general.
- Fixation of air conditioning and parabolic antennas.
- Fixation of bookcases.

**Advantages:**

- Applicable on hollow and solid materials.
- Suitable for reduced edges distance and spacing.
- Does not drip in ceiling applications.
- Includes 2 mixing nozzles.
- Easy dosage.
- Re-usable.

**EV2 Epoxy Chemical Anchor**  
Based on Styrene-Free Vinylester

The EV2 chemical anchor is a two-component Epoxy resin for heavy, high-performance loads, rapid curing and low odour, based on styrene-free vinylester technology with high reactivity. It provides very good chemical resistance in highly aggressive environments or under humid conditions, even in underwater anchors.

**Applications:**

- Heavy machinery and exigent fixation applications in slab work and concrete.
- Fixation of cranes.
- Anchors for prefabricated elements.
- Fixation of handrails.
- Road signposts.
- Hollow walls.
- Fixation even in humid environments.

**Advantages:**

- Recommended for heavy loads, both static and dynamic.
- Application on dry or wet surfaces. Even under water.
- High chemical resistance: suitable in aggressive environments.
- For medium-large diameter drills and high embedding depths.
- Includes 2 mixing nozzles.
- Re-usable.

**EV3 Epoxy Acrylate Anchor**  
Anchor Based on Styrene-Free Vinylester

The EV3 is a two-component resin of styrene free epoxy acrylate for use in concrete and masonry. It is designed as a fast curing, high strength resin fixing anchor for very high loads and critical fixings especially in corrosive environments or damp conditions.

**Applications:**

- Solid and hollow substrates.
- Outside lights ( lighting elements for balconies / terraces)
- Pool ladder. Rebar and threaded installations
- Heavy poles, lanterns
- Hanging cabinets
- Window shutters.

**Advantages:**

- Medium and heavy duty load applications
- Application on dry or wet surfaces. Even under water.
- High chemical resistance: suitable in aggressive environments.
- For medium-large diameter drills and high embedding depths.
- Includes 2 mixing nozzles.
- Styrene free
- Re-usable

Packaging	Content	Code	EAN13 barcode No.	Units/box
Bag	10 ud	10043079	8411729262037	5

Packaging	Content	Code	EAN13 barcode No.	Units/box
Bag	10 ud	10043078	8411729261955	5

Packaging	Code	EAN13 barcode No.	Units box
Unit	10043095	8411729271367	1

Packaging	Code	EAN13 barcode No.	Units box
Unit	10025411	8411729330767	1

Packaging	Content	Colour	Index Code	EAN13 barcode No.	Units/box
Cartridge	300 ml	Grey	10043065	8411729256685	12
	410 ml	Grey	10045224	*	12



Product video



\*\*Please get in touch with the Customer Service division for the activation date of the new codes (atencionalusuario@selena.com)

Packaging	Content	Colour	Index Code	EAN13 barcode No.	Units/box
Cartridge	300 ml	Grey	10042375	8411729053062	12
	410 ml	Grey	10045226	*	12



\*\*Please get in touch with the Customer Service division for the activation date of the new codes (atencionalusuario@selena.com)



## WATERPROOFING SYSTEMS



AquaProtect is a very complete range of waterproofing products developed using new technology for the repair, sealing and waterproofing of surfaces exposed to water, to UV rays and to severe weathering conditions. They guarantee a definitive solution to problems of humidity that may arise in buildings and private homes.

### Aqua Protect

- 98 Aqua Protect Liquid MS Silicone
- 98 Aqua Protect Leak Repairer
- 99 Aqua Protect Walkable P4
- 100 Aqua Protect Acrylic Rubber with microfibers
- 100 Aqua Protect Waterproofing Thermal Reducer

- 102 Water repellent for Facades and Roofs
- 102 Water repellent for Floors
- 103 Bitumen tape
- 103 Primer for waterproofing acrylic-based

### Cool-R System

- 105 Cool-R



ETA 120123 ETAS 001 part 1&5  
MS-M24/ rebar ø8-25mm  
For use in uncracked concrete  
M12-M16 threaded bars  
For use in cracked concrete  
European Technical Approval



Product Video



## AQUA PROTECT Liquid MS Silicone

Elastic coating, based on MS technology, ready to use, cures at room temperature in contact with air humidity, for waterproofing and repairing works.

### Applications:

- Waterproofing and protection of flat and sloping roofs, gutters, terraces (passable for maintenance or sporadically), joints in chimneys, skylights and ventilation outlets.
- Applicable on the most common materials in construction and waterproofing, metals in general (copper, zinc, aluminum, stainless steel, etc), thermal insulations (polyurethane, polystyrene), wood (agglomerate, plywood).
- Especially suitable for repairing leaks, joints between roofs and joints between ducts and joinery.

### Advantages:

- ETAG 005 certification (W2/W3) that provide a working life of 10/25 years.**
- Applicable even on wet surfaces and under rain.
- Great filling capacity.
- High resistance to stagnant water and UV rays.
- Does not need primer, except on bitumen applications.
- Does not shrink.
- May be used as adhesive for ceramic flooring.
- 400% elastic.
- Paintable.

Packaging	Content	Colour	Code	EAN13 barcode No	Units/box
Can	1 kg	White	10043741	8411729492625	6
		Grey	10042281	8411729030612	6
		Black	10042284	8411729030957	6
		Terracota	10042282	8411729030797	6
5 kg		White	10043742	8411729492700	2
		Grey	10042285	8411729031114	2
		Black	10042287	8411729031602	2
		Terracota	10042286	8411729031299	2
25 kg		White	10042271	8411729028084	1
		Grey	10042291	8411729032517	1
		Black	10042297	8411729033279	1
		Terracota	10042296	8411729033194	1



## AQUA PROTECT Leak Repairer

Express waterproofing, based on MS technology, ready to use, curing in ambient temperature by reaction with humidity, with high weather resistance that prevents and repairs damage to roofs, walls and terraces.

### Applications:

- Specially indicated for the reconstruction and repair of leaks, singular points in terraces, canalizations, gutters, downpipes, pipes and drains. Applicable on all types of surfaces: joints in chimneys, skylights and ventilation outlets, roof to vertical wall junctions, protection of vertical and horizontal anchors (lightning rods, satellite dishes and lighting) and work on vertical or inclined planes.

### Advantages:

- Suitable for wet areas.
- High filling and bridging capacity for cracks and crevices.
- High resistance to stagnant water and ultraviolet rays and different weather conditions.
- Can be applied without primer.
- Very good adhesion to wide range of common construction materials (concrete, cement, ceramic tiles, roof tiles, etc.)
- High elasticity (up to 400 %).
- Paintable.

Packaging	Content	Colour	Code	EAN13 barcode No	Units/box
Can	1 kg	White	10043464	8411729424817	6
		Grey	10043467	8411729425319	6
		Terracota	10043468	8411729425494	6



## AQUA PROTECT Walkable P4

Elastic coating based on MS technology. The product is ready to apply, curing in ambient temperature by reaction with humidity for waterproofing and repairing pedestrian roofs and terraces.

### Applications:

- Especially suitable for reconstruction and repair of leaks, joints between tiled roofs and entry points of pipework.
- Waterproofing and protection of pedestrian roofs and terraces, flat and sloping roofs, gutters, joints at chimneys, skylights and ventilation outlets. Can be used for common materials in construction and waterproofing, metals in general (copper, zinc, aluminum, stainless steel, galvanized sheet, etc.), thermal insulation, (polyurethane), wood (fiber board and plywood), the second layer of the product can be used for bonding ceramic tiles.

Packaging	Content	Colour	Code	EAN13 barcode No	Units/box
Can	5 kg	Grey	10043397	8411729404444	2
		Terracotta	10043398	8411729404512	2
	25 kg	Grey	10043424	8411729410537	1
		Terracotta	10043442	8411729414597	1

25 YEAR WARRANTY		AQUA PROTECT		CONTINUOUS TRAFFIC	
	W3	P4			
10 YEAR WARRANTY	W2	P3			OCCASIONAL WARRANTY
MINIMUM WARRANTY	W1	P2			MAINTENANCE ONLY
		P1			NON-WALKABLE

### Advantages:

- Classification by internal tests according to ETAG 005:
  - P4, pedestrian transit
  - W3, complies with the requirements of 25 years life expectancy
  - Climatic zone S (severe)
- No feeling of tack.
- Can be applied without primer except on bitumen surfaces.
- Suitable for wet areas.
- Waterproof. Can be used even in areas with standing water in roofs and terraces.
- Permeable to water vapour.
- High resistance to ultraviolet rays and different weather conditions.
- Paintable. Does not contaminate for subsequent paint applications.
- Anti-mould. Doesn't blacken.



## AQUA PROTECT Acrylic Rubber with microfibers

Liquid resin based on acrylic with addition of fibres, creating an elastic, waterproof coating designed for repair works on flat roofs, terraces and balconies. Ultra-thin microfibers give very high mechanical properties.

### Applications:

- Renovation of coverings on new and old concrete roofs, metal roofs, old and new bituminous roofs and tiles and gutters without standing water. Should be applied with roller. It is compatible with different type of surfaces such as bitumen sheeting, concrete, ceramic tiles, galvanized steel sheet, stainless steel and aluminum. Ambient temperature during application from +15°C to 35°C.

### Avantages:

- Great resistance to micro-cracks
- Extended elasticity (300%)
- Low water absorption
- High durability – up to 15 years
- High resistance to changing weather conditions, ensuring high and stable quality of repairs for many years.

## AQUA PROTECT Waterproofing Thermal Reducer

Liquid resin with new reflective technology reinforced with ultrafine microfibers that contributes to energy saving and efficiency. High level of solar reflectance and emissivity that releases most of the absorbed heat and reflects UV rays, reducing the temperature on the applied surface, thus achieving a significant improvement in thermal comfort inside the building.

### Applications:

- Renovation of coverings on new and old concrete roofs, metal roofs, old and new bituminous roofs and tiles and gutters without standing water. Should be applied with roller. It is compatible with different type of surfaces such as bitumen sheeting, concrete, ceramic tiles, galvanized steel sheet, stainless steel and aluminum. Ambient temperature during application from +15°C to 35°C.

### Avantages:

- High level of solar reflectance and emissivity (SRI=89)
- Great resistance to micro-cracks
- Extended elasticity (300%)
- Low water absorption
- High durability – up to 15 years
- High resistance to changing weather conditions, ensuring high and stable quality of repairs for many years.

## LIQUID WATERPROOFING TECHNOLOGIES

Comparative Table

	P4 WALKABLE	MS LIQUID SILICONE	LIQUID SILICONE	PU'S POLYUREA	MICROFIBERS RUBBER	THERMAL REDUCER	ACRYLIC
<b>Stagnant water resistance</b>	Excellent	Excellent	High	High	Medium	Medium	Low
<b>Transitability</b>	Excellent	Medium	Low	High	Low	Low	Low
<b>UV Resistance</b>	High	High	High	Medium	Medium	Medium	Medium
<b>Adhesion on wet surfaces</b>	Medium	Medium	Medium	Low	Low	Low	Low
<b>Energetic efficiency</b>	Medium	Medium	Medium	Low	High	Excellent	Medium
<b>Elasticity throughout aging</b>	Excellent	Excellent	High	Medium	High	High	Medium
<b>Large areas</b>	High	Medium	Medium	High	High	High	High
<b>Sustainability</b>	Medium	Medium	Medium	Low	High	Excellent	Medium
<b>High filling capacity</b>	High	High	High	High	Medium	Medium	Low
<b>Ease of application</b>	Excellent	Excellent	Medium	Low	High	High	Medium
<b>Needs primer</b>	No	No	Yes	Yes	Yes	Yes	Yes

Packaging	Content	Colour	Code	EAN13 barcode No	Units/box
Pail	20 kg	Grey	10041628	8411729418892	2
		Terracota	10041630	8411729420284	2

Packaging	Content	Colour	Code	EAN13 barcode No	Units/box
Pail	20 kg	White	10041629	8411729421359	2



## Water Repellent for Facades and Roofs

Siloxane resin-based, colorless, water-repellent liquid in organic solvent, for protecting construction materials, providing water repellency.

### Applications:

- Waterproofing treatment on walls and roofs exposed to rain, maintaining the original appearance of the materials. Ideal for protecting exterior walls of brick, stone or roofs, monuments and porous materials that need to be waterproofed while maintaining their original appearance.
- Do not use on non-porous materials, waxed or oiled materials, wood, etc.

### Advantages:

- Anti-moss.
- Invisible (Transparent).
- Anti-humidity.
- Resistant to UV rays.
- Does not give shine, maintaining materials' natural appearance .



## Water Repellent for Floors

Siloxane and fluorosilane resin-based, colorless, water-repellent liquid in organic solvent, for protecting porous floors from humidity, grease stains and oils.

### Applications:

- Protection treatment for floors on absorbent construction materials:
  - Terraces.
  - Balconies.
  - Patios.
  - Gardens.
  - Barbecues, etc.
- Do not use on non-porous materials, waxed or oiled materials, wood, etc..

### Advantages:

- Anti-moss - Anti-humidity - Anti-stain.
- Invisible (Transparent).
- Passable.
- Resists UV rays.
- Repels water and oil.



## Bitumen Tape

Self-adhesive, bitumen waterproofing tape protected with aluminum film. Its strong adherent power makes it ideal for sealing, waterproofing and protecting any surface.

### Applications:

- Protection and repair of different types of roofing (metal, plastic, fiber-cement).
- Sealing of frames and skylights, railings, glass and plastic structures.
- Sealing of concrete joints, covering of openings between window frames and walls.
- Repair of tiles, gutters, metal tubes, fiber-cement roofs and metal panels.

### Advantages:

- Versatile and easy to use. Easy and rapid cold application.
- Excellent resistance to weathering and UV rays.
- Good initial sealing and strong adherence.
- Great adherence to metals, wood, marble, ceramic, concrete, stone and some types of plastic.



## Primer for Waterproofing acrylic-based

Acrylic water based primer.

### Applications:

- Water-based primer that improves the adherence of liquid MS silicone on bituminous materials, preventing later decoloring due to migration of bitumen material components. For indoor and outdoor use.

### Advantages:

- Excellent coverage.
- Easy to apply with brush or roll.
- Ecological: Water-based product.
- Rapid drying.
- Low emissions. Solvent-free.

Packaging	Content	Colour	Code	EAN13 barcode No.	Units/box
Can	0,750 L	Colourless	10042177	8411729000349	6
	5 L	Colourless	10042179	8411729000752	2
	25 L	Colourless	10042459	8411729071387	1

Packaging	Content	Colour	Code	EAN13 barcode No.	Units/box
Can	0,750 L	Colourless	10042180	8411729001094	6
	5 L	Colourless	10042181	8411729001254	2
	25 L	Colourless	10042460	8411729071462	1

Packaging	Content	Colour	Code	EAN13 barcode No.	Units/box
Roll	10 cm x 10 m	Aluminium	10003753	8411729158187	3
	10 cm x 10 m	Terracota	1000375	8411729156770	3
	10 cm x 10 m	Black	10024903	8411729108199	3
	30 cm x 10 m	Aluminium	10024904	8411729108274	1
	30 cm x 10 m	Terracota	10024907	8411729108434	1
	30 cm x 10 m	Black	10024945	8411729124359	1

Packaging	Content	Colour	Code	EAN13 barcode No.	Units/box
Bottle	5 L	White (Transparent when dry)	10042821	8411729178062	1

## Highly Reflective Waterproof Coating



Cooling



Waterproofing



Reflective



Fire-resistant



Long-lasting



## Cool-R System

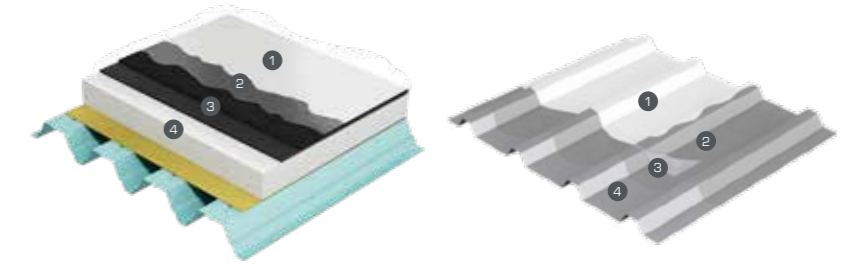

### System elements 1:

1. COOL-R White
2. COOL-R Grey
3. Bitumen panel
4. Thermal insulation

### Éléments du système 2:

1. COOL-R White
2. COOL-R Grey
3. Primer (optional)
4. Support

Metal, concrete and synthetic (PVC) surfaces

## COOL-R

Highly Reflective Waterproofing Coating.

### Applications:

- Flat metal roofs and concrete surfaces with bitumen/PVC covering.
- Rehabilitation of roofing.
- Production plants, logistics centers, shopping malls.

### Advantages:

- Eliminates problems of roofs overheating.
- Protects the roof against the adverse effects of solar radiation.
- High-feature, continuous waterproofing coat.
- Light load for the roof structure.

### System elements:

1. Cool-R White (0,9 kg/m<sup>2</sup>)
2. Cool-R Grey (0,9 kg/m<sup>2</sup>)
3. Primer Waterproof (0,2 kg/m<sup>2</sup>)
4. Support

### Without application of reinforcement (metal, synthetic coat) .

	Color	Consumption	Thickness for a single layer
Cool-R (lower layer)	Grey	0,9 Kg/m <sup>2</sup>	0,5 mm
Cool-R (upper layer)	White	0,9 Kg/m <sup>2</sup>	0,5 mm

The total thickness of the cover once dry should be  $\geq 1,0$  mm.

### With application of reinforcement (concrete) .

	Color	Consumption	Thickness for a single layer
Cool-R (lower layer)	Grey	1,5 Kg/m <sup>2</sup>	1,1 mm
Cool-R (upper layer)	White	0,8 Kg/m <sup>2</sup>	0,5 mm

The total thickness of the cover once dry should be  $\geq 1,6$  mm.



- Reduces the temperature in the interior of the buildings once applied on the roofs
- Reduces energy consumption
- Extends the lives of roofs
- Solar Reflectance Index (SRI): 107
- Excellent resistance to UV rays
- Elastic
- Passable
- Resistant to stagnant water

COOL-R is a highly reflective waterproofing coating that combines the benefits of reducing temperature inside buildings and an excellent waterproofing film for the roof surface.

Thanks to its innovative technology, the Cool-R coating has a high SRI value (Solar Reflectance Index = 107) and high waterproofing performance. The roof temperature will be reduced up to 70%, and inside the building up to 10°C with the use of COOL-R.

Packaging	Content	Colour	Code	Barcode	Units/box
Pail (COOL-R)	15 kg	Blanc	10036182	8411729220877	1
		Gris	10036183	8411729220952	1

Packaging	Measurement	Code	Barcode	Units/box
Horizontal Reinforcement	115 cm x 200 m	10036182	5902120114030	1
Vertical Reinforcement	15 cm x 100 m	10036183	5902120114023	1



Product video

## FLOORING SYSTEMS

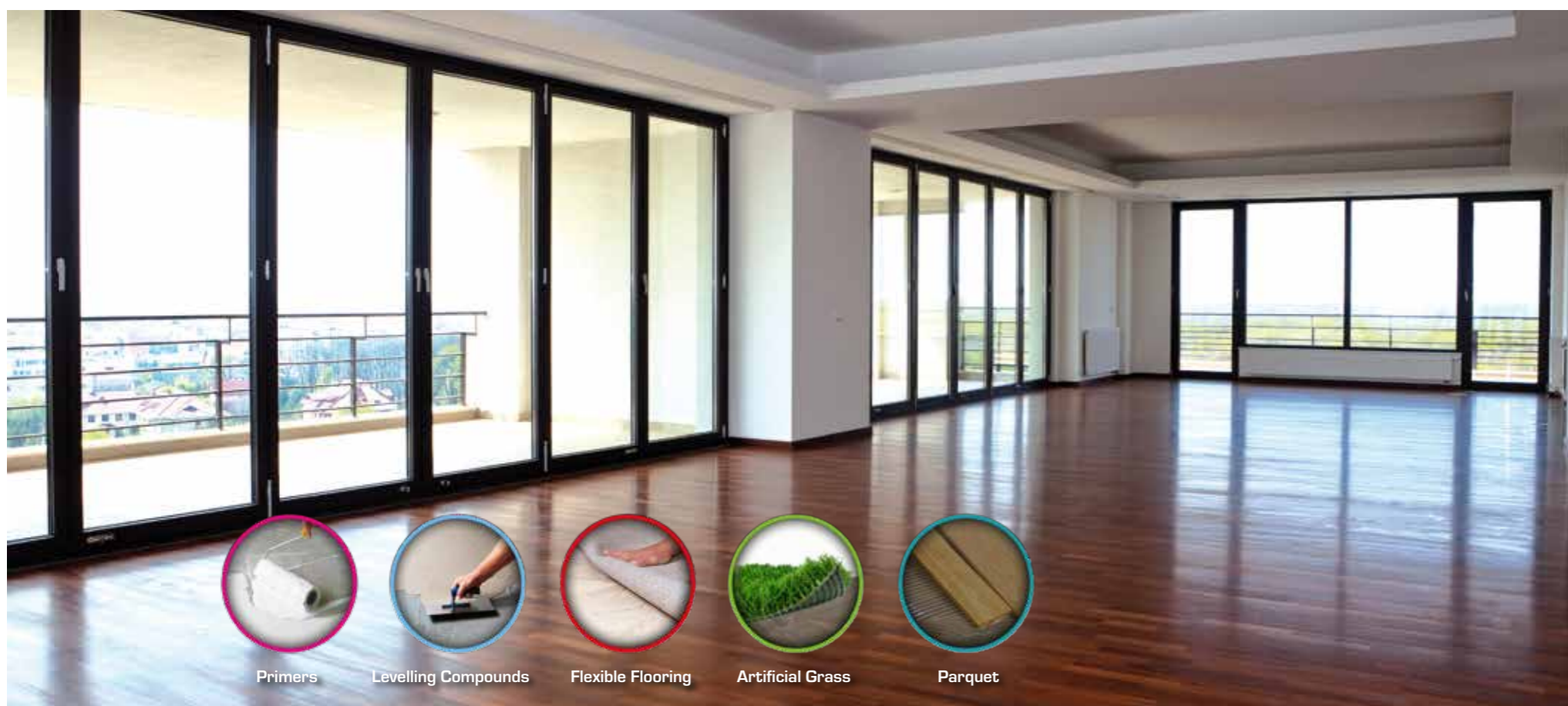

Primers

Levelling Compounds

Flexible Flooring

Artificial Grass

Parquet

### Primers and self-levelling pastes

- 100 Quilosa WB-290
- 100 Quilosa WB-280
- 100 Quilosa LC-735
- 101 Quilosa LC-705
- 101 Quilosa LC-410

### Adhesives

- 103 Quilosa BH-210 Adhesive for parquet flooring
- 103 Quilosa BP-385 Adhesive for parquet and flexible flooring
- 104 Quilosa BA-376 Adhesive for resilient flooring
- 104 Quilosa WB-981 Walls and Floors Adhesive
- 104 Quilosa BP-984 Removable Adhesive

### Artificial Turf Installation System

- 105 Quilosa Band Union
- 105 Quilosa BP-390 Artificial Grass Adhesive

The QUILOSA range of products for flooring includes primers, levelling compounds and adhesives. As a response to the most demanding professional users' requirements, they have been developed to combine quality, reliability and easy application.

Our main priority is our customers' satisfaction, through the highest product quality and specialised assistance.



## Quilosa WB-290

### Primer

Absorbent and non-absorbent surfaces

Primer resistant to saponification that reduces absorption and increases adherence of self-levelling pastes to cement-based flooring, while also protecting plaster surfaces against humidity.

#### Applications:

- Application on surfaces of cement, concrete, anhydrite and wood.
- Ideal for the application under demanding conditions or on difficult surfaces, even without levelling paste.
- Indoor and outdoor use.

#### Advantages:

- Odourless and solvent-free.
- Pigmented for identifying treated surfaces.
- Suitable for radiant flooring.
- High performance. Can be diluted in a proportion of 1:5.
- For walls and floors.
- Application with roller or brush.

## Quilosa WB-280

### Primer

For Non-Absorbent surfaces

Primer for improving adhesion on vitrous and non-absorbent substrates. Especially suitable for laying on old vinyl, linoleum and rubber coverings.

#### Applications:

- Old substrates such as ceramic tiles, natural stones and terrazzo.
- Insufficient sanded mastic asphalt, screeds or rolled asphalt concrete.
- Old sealed/coated surfaces.
- Old smooth and tight concrete substrates.

#### Advantages:

- Odourless and solvent-free.
- One component, ready for use.
- On walls and floors.
- Provides optimum adhesion.
- Good skid resisting properties.
- Short waiting time.
- Easy to apply by roller.
- Low consumption / high coverage.
- Suitable for application on subfloor heating systems.

## Quilosa LC-735

### Self-Levelling Compound

Thickness up to 35 mm

Rapid-setting, self-levelling paste for filling, smoothing and levelling all types of flooring. It contains fibres for greater flexibility and durability.

#### Applications:

- Use on floors of cement, concrete and anhydrite prior to the installation of PVC flooring, carpeting, linoleum, parquets, ceramic, tiles and stone slabs.
- Indoor and outdoor use.

#### Advantages:

- Can be applied to surfaces temporarily exposed to increased humidity (bathrooms, kitchens, basements, garages).
- Suitable for radiant flooring.
- Thickness of 5 to 35 mm.
- Resistance to compression > 35N/mm<sup>2</sup>

## Quilosa LC-705

### Self-Levelling Compound

Maximum thickness 5 mm

Cement-based self-levelling paste, thickness maximum 5 mm. Self-levelling, fast setting, thin-set mortar thickness to apply before placing the floor coverings.

#### Applications:

- Sealing, smoothing and levelling on concrete floors, cement, anhydrite, plasterwork, non-absorbent substrates (after priming)... before installing all types of floors, such as PVC, parquet, textiles, flexible tiles, ceramic, stone or linoleum.
- Indoor use.

#### Avantages:

- Easy application.
- Thickness from 2 to 5 mm.
- Consumption: 1.5 kg/m<sup>2</sup>.
- Compressive strength > 20N/mm<sup>2</sup>.

## Quilosa LC-410

### Self-Levelling Compound

Thickness up to 10 mm

Cement-based self-levelling paste, thickness up to 10 mm.

#### Applications:

- For filling, smoothing and levelling of cement, concrete and anhydrite floors prior to the installation of PVC or textile covering.
- Indoor use.

#### Advantages:

- Easy application.
- Thickness of 2 to 10 mm.
- Consumption: 1.5 kg/m<sup>2</sup>.
- Classification CT-C16-F5.

Packaging	Content	Code	EAN13 barcode No.	Units/box
Jerrycan	10 Kg	10000159	8411729409562	1

Packaging	Content	Code	EAN13 barcode No.	Units/box
Jerrycan	5 Kg	10040923	8411729409647	1

Packaging	Content	Code	EAN13 barcode No.	Units/box
Bag	25 Kg	10034100	8411729417154	1

Packaging	Content	Code	EAN13 barcode No.	Units/box
Bag	25 Kg	10000239	8411729394387	1

Packaging	Content	Code	EAN13 barcode No.	Units/box
Bag	25 Kg	10043378	8411729394462	1



## Parquet Flooring System



**QUILOSA LC-410**  
Self-levelling compound  
Thickness up to 10 mm

**Quilosa BH 210**  
Hybrid wood adhesive

**QUILOSA WB-290**  
Primer  
Absorbent and non-absorbent surfaces

## Flexible Flooring Systems heavy traffic and humid environments



**QUILOSA LC-735**  
Self-levelling compound  
Thickness up to 35 mm

**QUILOSA BP-385**  
2K Polyurethane Adhesive

**QUILOSA WB-290**  
Primer  
Absorbent and non-absorbent surfaces

## Flexible Flooring System



**QUILOSA LC-410**  
Self-levelling compound  
Thickness up to 10 mm

**QUILOSA BA-376**  
Flexible flooring adhesive

**QUILOSA WB-290**  
Primer  
Absorbent and non-absorbent surfaces



## Adhesive for Flooring



### Quilosa BH-210 All types of wood flooring

Modified polyurethane-based flexible single-component hybrid adhesive, STP.

**Applications:**

- Specially developed for the installation of special parquets, laminated parquet, wood planks from coating, resin-treated parquet floors, varnished parquet, plywood parquet and exotic wood parquet (teak, bamboo, etc.). It has an excellent adhesion to most substrates, including wood, concrete and stone. Recommended for all types of parquet (size/origin). Porous and non-porous surfaces.

**Advantages:**

- Highly elastic
- For all types of construction surfaces
- All types of parquets
- Odorless, does not contain isocyanates.
- Suitable for underfloor heating
- Suitable for radiant flooring.

### Quilosa BP-385 Parquets and resilient floorings

Two-component, polyurethane adhesive for parquet and flexible flooring.

**Applications:**

- Suitable for bonding all types of parquet and flexible flooring in conditions of heavy traffic and humid environments.
- Suitable for facilities with very high traffic such as loading areas, sports centres, metros, industrial kitchens, etc.

**Advantages:**

- Resistance to heavy traffic.
- Applicable on floors with up to 4% humidity.
- Excellent resistance to water.
- Indoor and outdoor use.
- Suitable for radiant flooring.
- Suitable for wheelchairs.
- Consumption 500 g/m<sup>2</sup>

Packaging	Content	Code	EAN13 barcode No.	Units/box
Pail	15Kg (5kg x 3)	10003674	8411729388850	1

Packaging	Content	Code	EAN13 barcode No.	Units/box
Pail + Can	7+1 Kg	10043370	8411729391980	1





## Quilosa BA-376

Adhesive for Flooring

Water-based adhesive for flexible flooring.

### Applications:

- Installation of linoleum, homogeneous and heterogeneous PVC roll and tiles, PVC-backed punched fibre.
- Suitable for areas with intense traffic.

### Advantages:

- Solvent-free.
- High initial tack.
- Easy to spread.
- Flexible joint.
- Suitable for radiant flooring.
- Suitable for wheelchairs.
- Consumption: 350-450 g/m<sup>2</sup>

## Quilosa WB-981

Walls and Floors Adhesive

It is ideal for gluing flexible floor and wall coverings onto absorbent and non-absorbent substrates indoors. Ready to use, acrylic dispersion, solvent-free, specialised adhesive for floor coverings. Optimal initial grip.

### Applications:

- For interior use, bonding on floors and walls.
- Bonding homogenous and heterogenous PVC coverings.
- Bonding LVT, PVC coverings with PU backing.
- Bonding textile floor coverings.
- Bonding linoleum.

### Advantages:

- For use in a wide range of applications.
- Can be used for bonding wallcoverings.
- High tack.
- Can be thermally activated.
- Easy application, can be applied by roller
- Suitable for radiant flooring.
- Suitable for wheelchairs.
- Solvent-free and Neutral odour.

## Quilosa WB-984

Removable Adhesive

Adhesive in dispersion for bonding self-supporting (removable) technical flooring. Characterised by its high tack and low consumption. This product provides a film that guarantees the possibility to lift the floor coating indefinitely over time.

### Applications:

- Recommended for fixing textile covering with different backings (special felt backs), PVC floor coatings, self-supporting coverages on floors.
- Application with spatula or with roller.

### Advantages:

- Lasting fixation.
- Low consumption. It can be mixed with up to 50% water to reduce adherence.
- Suitable for radiant flooring.
- Easy to remove floor coverage.
- Application with roller.

Packaging	Content	Code	EAN13 barcode No.	Units/box
Pail	1 Kg	10043730	8411729490232	6
	6 Kg	10043731	8411729490317	1
	20 Kg	10043361	8411729389277	1

Packaging	Content	Code	EAN13 barcode No.	Units/box
Pail	20 Kg	10024356	8411729389437	1

Packaging	Content	Code	EAN13 barcode No.	Units/box
Pail	12 Kg	10000394	8411729390730	1

## GARDEN & POOLS



Artificial Turf Installation System  
116 Quilosa Band Union  
116 Quilosa BP-390 Artificial Grass Adhesive

Swimming Pools  
117 Swimming Pool Sealant  
117 Pool's Putty

Special Adhesives  
118 Aquariums and Terrariums  
118 Mirror Silicone  
118 Marble Silicone



## Quilosa Band Union

Artificial Turf. Glue tapes for sports fields and artificial turf

Geotextile band with fibrous veil and multilayer structure for joints in artificial turf installations, to join different rolls of artificial grass to each other. Excellent resistance, thanks to which you can make your pieces look like one. Combined with our artificial turf glue we will make our artificial turf to be totally fixed and adhered.

### Applications:

- Tapes for single spread and double spread glueing of artificial turf
- Tested at ISA Sport (Institute for Sports Accomodations) and meet the highest standards of, among others, FIFA and World Rugby.

### Advantages:

- Dimensional stability.
- Total impermeability to the glue.
- High resistance to humidity.

Packaging	Content	Color	Code	EAN13 barcode No.	Units/box
Roll	30cm x 10m	White	10043544	8411729444204	1
	30cm x 100m	White	10043543	8411729444129	1



## Quilosa BP-390

Artificial Grass Adhesive

2-component polyurethane adhesive for artificial grass.

### Applications:

- Designed for the installation of gardening and sports applications (soccer fields, paddle courts, etc.).

### Advantages:

- Green colour.
- Excellent resistance to weathering and humidity.
- Indoor and outdoor use.
- Applicable on floors with up to 4% humidity.
- Consumption: 500 g/m<sup>2</sup>

Packaging	Content	Color	Code	EAN13 barcode No.	Units/box
Cartridge	280 ml	Green	10044781	8411729000325	12
Pail + Can	10+1 Kg	Green	10043371	8411729392062	1



## Swimming Pool Sealant

Neutral Silicone

High performance neutral silicone. Fit for sealing joints in swimming pools and all kind of surfaces in permanent contact with water.

### Applications:

- Tile bonding. Even underwater.
- UV resistant. Fit for outdoor applications.
- All kind of materials
- Repairing of joints, cracks, and ladder anchorings or attachments.
- Reconstruction of poolside areas and pool entrances.

### Advantages:

- Resists constant submersion.
- Highly durable.

Packaging	Content	Color	Code	EAN13 barcode No.	Units/box
Cartridge	290 ml	White	10044653	*	12

\*Please get in touch with the Customer Service division for the activation date of the new codes (atencionalusuario@selena.com)



## Pool's Putty

Bind & Seal

MS Polymer-based adhesive sealant fit for use on swimming pools.

### Applications:

- Bonding of mosaics and tiles. Even underwater.
- Transitional fix of cracks in concrete and PVC.
- Watertight joints in swimming pools.
- Repairing of swimming pools.
- Bonds on: Brick, Ceramic, Concrete, Stone, Polystyrene, Polycarbonate, Glass, PVC, Wood, OM, Aluminium, Metals, Plastics..

### Advantages:

- Applicable over wet surfaces.
- Fit for indoors and outdoors.
- Resists temperatures between -40°C and 90°C.
- Highly resistant to UV and damaging weather conditions.
- Powerful bonding: Up to 250 Kg/10cm<sup>2</sup>.

Packaging	Content	Color	Code	EAN13 barcode No.	Units/box
Cartridge	280ml	Blue	10042457	8411729070700	12



## Aquariums and Terrariums

Seal & bind

Neutral silicone. Developed to be safe for usage in aquariums with live fish. Fit for the sealing of joints in terrariums, aquariums, and continuously submerged surfaces.

### Applications:

- Sealing and mounting of decorative elements.
- Repairing of water leaks.
- Superb waterproofing performance.

### Advantages:

- Special "ergo-straw" for hard-to-reach areas.
- Completely harmless for fish, reptiles, amphibians and other animals.
- Resistant to sunlight.

## Mirror Silicone

Seal & Bind

High performance neutral silicone fit for the binding and sealing of mirrors and inner panels on all kinds of materials.

### Applications:

- High resistance.
- Sealing and mounting of decorative fixtures.
- Flexible and strong joints.

### Advantages:

- Stain-free mirrors.
- "Tack"-free: non-sticky.
- Special "ergo-straw" for hard-to-reach areas.

## Marble Silicone

Seal & Bind

High performance neutral silicone specially formulated for use on stone surfaces. It does not stain natural stone surfaces, such as marble or granite.

### Applications:

- Sealing and bonding of floorings, staircases, skirting boards, bathroom counters, and marble, granite, or stone-made kitchen fittings.
- Sealing of bathrooms and kitchens.
- Sealing of aluminum, laquered aluminum, wood, glass, tiles, ceramic surfaces, cement, concrete, marble, granite, and natural stone.

### Advantages:

- High UV and weather resistance.
- Special "ergo-straw" for hard-to-reach areas.
- Does not leave stains on natural stone surfaces.
- Superb waterproofing performance.
- High elasticity.

Packaging	Content	Color	Code	EAN13 barcode No.	Units/box
Cartridge	300 ml	Black	10042454	8411729070397	12
	290 ml	Clear	10042500	8411729080525	6

Packaging	Content	Color	Code	EAN13 barcode No.	Units/box
Cartridge	300 ml	White	10042395	8411729058760	12
	290 ml	Clear	10042395	8411729058760	12

Packaging	Content	Color	Code	EAN13 barcode No.	Units/box
Cartridge	290 ml	Clear	10042452	8411729069735	12

## FIRE STOP



Passive Anti-Fire Protection  
 123 Orbasil N-28 FIRE STOP  
 123 Sintex AC-41 FIRE STOP  
 124 Orbafoam FIRE-STOP B1  
 124 Sintex FIRE STOP Refractory

Protection against High Temperatures  
 125 Orbasil N-65 FIRE STOP High Temperatures  
 125 Orbasil K-88 FIRE STOP High Temperatures

QUILOSA'S FIRE STOP range of products meets the demands of passive protection regulations against fires.

The technical building code (CTE) establishes the conditions of protection against fire in the buildings.

Protection against fire comprises a series of measures intended to:

- Prevent fire from starting.
- Limit the effects of the fire if it starts.

Classification of fire protection measures:

Passive: products that if subjected to fire keep their properties at least along a certain period of time without propagating the fire. E.g: fire doors, sealants, etc.

Active: Their function is to extinguish the fire. E.g.: Extinguishers, sprinklers.

These products should be used in: hospitals, administration centers, schools, garages, shopping malls, industrial buildings, etc.

In any type of building or industrial machinery, all joints, holes and cracks that can transmit flames, heat or smoke from a fire should be sealed with QUILOSA anti-fire systems to minimize damage.

QUILOSA's FIRE STOP products for passive fire protection have been tested and classified in accredited laboratories, according to fire resistance standards UNE-EN 1366-4 / UNE-EN 13501-2 which guarantee compliance with the effective legislation.



## Resistant products to fire and high temperatures



EI 240



### Orbasil N-28 FIRE STOP

Classified up to EI240 according to UNE EN 1366-4 / 13501-2 ISO11600 F+G 25LM  
Fire-resistant, oxime neutral silicone.

**Applications:**

- Sealing of expansion joints in firewalls and slab work.
- Sealing of connections, pipes, cable ducts, etc., where fire protection is required.
- Sealing of firewall doors.

**Advantages:**

- Up to 4 hours' fire resistance.
- High resistance to weathering and UV rays.
- Elastic.

EI 240



### Sintex AC-41 FIRE STOP

Classified EI240 according to UNE EN 1366-4 / 13501-2 ISO11600 F 12,5 P  
Fire-resistant acrylic sealant.

**Applications:**

- Sealing of low-movement joints in firewalls and slab work.
- Sealing of connections, metal pipes, cable installations, door or window frames that require protection against the fire.

**Advantages:**

- Up to 4 hours' fire resistance.
- Paintable.

	ORBASIL N-28	SINTEX AC-41	ORBAFOAM FIRE STOP	ORBASIL K-88	ORBASIL N-65	SINTEX REFRACTORY
<b>FIRE RESISTANCE</b>	High	High	High			High
<b>TEMPERATURE RESISTANCE</b>				Up to 325°C	Up to 315°C	Up to 1.500°C
<b>CERTIFICATION FIRE RESISTANCE</b>	EI 240	EI 240	EI 240			
<b>JOINT MOVEMENT</b>	High	Low	Low	High	High	
<b>PAINTABLE</b>		High	High			High
<b>NORM</b>	UNE EN 1366-4/13501-2	UNE EN 1366-4/13501-2	UNE EN 1366-4/13501-2			

Packaging	Content	Colour	Code	EAN13 barcode No.	Units/box
Cartridge	300ml	White	10043150	8411729306762	24
		Pearl Grey	10003728	8411729241582	12
Aluminium Bag	600ml	Pearl Grey	10043308	8411729367985	12

Packaging	Content	Colour	Code	EAN13 barcode No.	Units/box
Cartridge	300ml	Pearl Grey	10043033	8411729241827	24
Aluminium Bag	600ml	White	10043375	8411729393472	12
		Pearl Grey	10043149	8411729306687	12
		Beige PRE	10043269	8411729358167	12



## Orbafoam FIRE STOP B1

**Classified EI240 according to UNE EN 1366-4 / 13501-2**  
B1 polyurethane foam for passive fire protection.

**Applications:**

- B1 polyurethane foam for passive fire protection.
- For sealing, insulating and filling joints, cracks and holes where fire compartmentation is required. Ideally suited for fire-proof doors mounting, insulation and filling of cable ducts (not suitable for fireplaces and stoves). Assembly of door and windows frames.

**Advantages:**

- Provides stability and insulation against fire up to 4h.
- Resists smoke and gases.
- Thermal and acoustic insulation.
- Shelf life: 12 months.

Packaging	Content	Colour	Code	EAN13 barcode No.	Units/box
Aerosol for straw	750 ml	Grey	10036223	8411729408169	12
Aerosol for gun	750 ml	Grey	10003282	8411729384067	12

HT 1500°C



## Sintex FIRE STOP Refractory

Refractory putty resistant to high temperatures and direct flame.

**Applications:**

- Permanent sealing and repair of joints, cracks and fissures in chimneys, heating units, ducts, refractory elements, etc.

**Advantages:**

- Resistant up to 1,500°C.
- Fire-proof.

Packaging	Content	Colour	Code	EAN13 barcode No.	Units/box
Cartridge	300ml	Black	10043034	8411729241902	12

HT 315



## Orbasil N-65 FIRE STOP High Temperatures

Neutral silicone resistant to high temperatures.

**Applications:**

- Bonding and sealing of panels, oven doors, smoke outlets, etc.
- Sealing of joints subjected to high temperatures: hot air or vapor ducts, ovens, smoke outlets, oil sumps and water pumps.
- Bonding and sealing in refrigerators and boilers.
- Manufacture of solar panels.

**Advantages:**

- Resistant to temperatures up to 200°C continually and 315°C occasionally.
- Elastic

Packaging	Content	Colour	Code	EAN13 barcode No.	Units/box
Cartridge	300ml	Grey	10043032	8411729241742	12

HT 325



## Orbasil K-88 FIRE STOP High Temperatures

Acid silicone resistant to high temperatures.

**Applications:**

- Hot air or vapor ducts up to 250°C.
- Ovens, smoke outlets, boilers, pump joints.
- Automobile industry: joints of the crankcase and the gearbox.

**Advantages:**

- Resistant to temperatures of 250°C continually and 325°C occasionally.
- Elastic.

Packaging	Content	Colour	Code	EAN13 barcode No.	Units/box
Cartridge	300 ml	Red	10043795	8411729610449	12

## DIY AND DECORATION



The DIY AND DECORATION product range covers a broad list of solutions for problems and needs in the home. From products for decoration, such as repair pastes, crack fillers, wallpaper glue, cork, vinyls... or products for masonry work, plasters, cements... completed with the range of varnishes for the highest quality handworks.

### Cracks Fillers and Repairs

- 129 Liteplast
- 129 Liteplast Wood
- 130 Bricofix Universal Crack Filler
- 130 Bricofix Crack Filler
- 130 Bricofix Levelling Paste

### Wallpaper Adhesives

- 131 Bricofix Wallpaper
- 131 Bricofix Vinyl Paper

### Tiling

- 132 Bricofix Paste for Joints
- 132 Bricofix Paste for Joints, powder
- 133 Bricofix White Cement Glue
- 133 Bricofix Grey Cement Adhesive
- 133 Bricofix Swimming Pools

### Wall and Repairs

- 134 Bricofix Plaster
- 134 Bricofix Plaster of Paris

### Bonding and Repairs

- 135 Bricofix Rapid Cement
- 135 Bricofix White Cement
- 136 Bricofix Barbecue and Chimneys
- 136 Bricofix Grey Cement
- 136 Bricofix Grey Mortar

### Spray Paints

- 139 Acrylic Paint General Use
- 140 White Electrodomeestic
- 140 Mate - Brillant Zinc
- 140 Gold - Silver Chrome - Effect
- 141 Heat Resistant
- 141 Universal - Metal - Plastic Primer
- 141 Marker Paint

### Lubricants

- 143 Quilube Aerosol
- 143 Quilube Grease



# LITEPLAST

Light, easy-to-apply repair paste



## Liteplast

Light, easy-to-apply repair paste.

**Applications:**

- Rapidly fills and repairs cracks, fissures, openings and holes in any types of surface: plaster, wood, plaster of Paris, walls, etc.

**Advantages:**

- Ready to use.
- Rapid drying.
- Does not shrink or crack even with significant thicknesses.
- Can be painted, varnished and sanded.
- Suitable for indoor and outdoor use.
- Super white finishing

## Liteplast Wood

Light repair paste for wood.

**Applications:**

- Rapidly fills and repairs holes and damage in wood.

**Advantages:**

- Ready to use.
- Rapid drying.
- Does not shrink or crack even with significant thicknesses.
- Can be painted, varnished and sanded.
- Suitable for indoor and outdoor use.

Ready to use.

Does not shrink or crack.

Can be painted, varnished and sanded.

Packaging	Content	Colour	Code	EAN13 barcode No.	Units/box
Tube	150ml	White	10042749	8411729161057	12
	250ml	White	10043812	8411729663407	24
Pail	750ml	White	10043813	8411729663575	12
	5l	White	10043814	8411729663810	2

Packaging	Content	Colour	Code	EAN13 barcode No.	Units/box
Pail	250ml	Pine	10042515	8411729089047	6
		Oak	10042516	8411729089122	6
		Sapelly	10042517	8411729089207	6
		Walnut	10043042	8411729244972	6
Tube	150ml	Pine	10042512	8411729088705	12
		Oak	10042513	8411729088880	12
		Sapelly	10042514	8411729088965	12
		Cherry	10043038	8411729244552	12
		Walnut	10043039	8411729244637	12



## Bricofix Universal Crack Filler

Acrylic resin for cracks, holes, repairs and fissures both in interiors and in exteriors.

### Applications:

- Putty to repair cracks, holes and crevices both indoors and outdoors.
- Crack filler to smooth irregularities in all kinds of porous surfaces, such as wood, plaster, cement, concrete, etc.

### Advantages:

- Ready to use. Easy to apply.
- Rapid drying.
- Indoor and outdoor use.

## Bricofix Crack Filler

Powder repair for damages in walls and ceilings. Indoor use.

### Applications:

- Repair of holes, cracks and fissures in interior walls and ceilings, up to a depth of 3mm.

### Advantages:

- Fine, decorative finish.

## Bricofix Levelling Paste

Powder for repair and levelling of irregularities in floors. Indoor use.

### Applications:

- Preparation of floors prior to installing parquet and carpet.

### Advantages:

- Does not crack or splinter.
- Excellent adherence.
- Rapid setting.

## Bricofix Wallpaper

Special powdered cellulose paste for hanging and bonding wallpaper. Indoor use.

### Applications:

- Bonding wallpaper.

### Advantages:

- Performance up to 7 rolls of thick paper or 10 rolls of thin paper.

## Bricofix Vinylpaper

Vinyl paste, ready to use for bonding vinyl paper, both simple and duplex. Indoor use.

### Applications:

- Bonding of vinylpaper and heavy paper.

### Advantages:

- Consumption of up to 5 m<sup>2</sup> per litre.
- Forms a transparent elastic film.

Packaging	Content	Code	EAN13 barcode No.	Units/box
Tube	150ml	10043905	8411729968830	12

Packaging	Content	Code	EAN13 barcode No.	Units/box
Box	1,5kg	10043870	8411729880132	10

Packaging	Content	Code	EAN13 barcode No.	Units/box
Box	1,5kg	10043871	8411729880620	10

Packaging	Content	Code	EAN13 barcode No.	Units/box
Box	125g	10043881	8411729883027	40

Packaging	Content	Code	EAN13 barcode No.	Units/box
Pail	800ml	10043882	8411729883102	12
	5l	10043883	8411729883287	2



## Bricofix Paste for Joints

Filling of joints on ceramic, both interior and exterior.

### Applications:

- To fill in any kind of joints between tiles, mosaics and tiles of floors and walls of kitchen and bathrooms.
- Can also be used to repair damaged joints in all types of porous surfaces, such as wood, plaster, cement, concrete, etc

### Advantages:

- Ready-to-use putty. Easy to apply.
- Indoor and outdoor use

Packaging	Content	Code	EAN13 barcode No.	Units/box
Tube	150ml	10043906	8411729969257	12



## Bricofix Paste for Joints, powder

Filling of joints on ceramic, both interior and exterior.

### Applications:

- Filling of joints on tiles and mosaics, both on floors and tiling of bathrooms and kitchens.
- Joints up to 3 mm thickness.

### Advantages:

- Impermeable.
- Lasting repair.
- Easy to clean.
- Indoor and outdoor use.

Packaging	Content	Code	EAN13 barcode No.	Units/box
Box	1,5kg	10043873	8411729881122	10



## Bricofix White Cement Glue

White cement adhesive for bonding ceramic covering. Indoor use.

### Applications:

- Bonding of stoneware, tiles, and mosaics. For indoor floors and walls.

### Advantages:

- Layer between 8 and 10 mm.
- High bonding reliability.

Packaging	Content	Code	EAN13 barcode No.	Units/box
Box	1,5kg	10042886	8411729198442	10



## Bricofix Grey Cement Glue

Grey cement glue for bonding ceramic covering. Indoor use.

### Applications:

- Bonding of stoneware, tiles, and mosaics. For indoor floors and walls.

### Advantages:

- Layer between 8 and 10 mm.
- High bonding reliability.

Packaging	Content	Code	EAN13 barcode No.	Units/box
Box	1,5kg	10043872	8411729881047	10



## Bricofix Swimming Pools

Special adhesive mortar for swimming pools. Repair in empty pools.

### Applications:

- Repairs of joints, cracks, anchors of ladders and fixings.
- Tile and vitreous materials fixing.
- Reconstruction of pool edges and accesses

### Advantages:

- Great resistance to immersion.
- Lasting repairs.

Packaging	Content	Code	EAN13 barcode No.	Units/box
Box	1,5kg	10043161	8411729313104	10

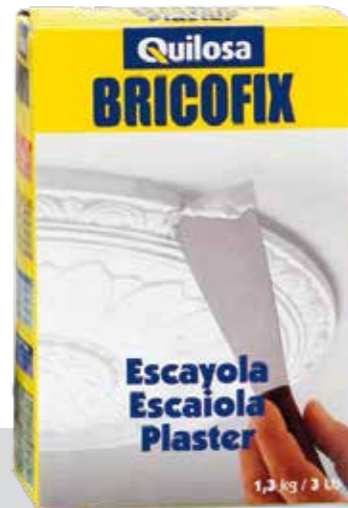

## Bricofix Plaster

Plaster. Indoor use.

### Applications:

- Bonding and repair of plaster pieces.
- Repair and finishing of ceilings and moulds.

### Advantages:

- Easy to use.
- Fine, decorative finish.

Packaging	Content	Code	EAN13 barcode No.	Units/box
Box	1,3kg	10043880	8411729882785	10
Bag	6kg	10043240	8411729346119	1 E*



## Bricofix Plaster of Paris

Plaster of Paris. Indoor use.

### Applications:

- Fitting of electric facility and plumbing boxes.
- Filling of indoor holes and frames.
- Plastering.

### Advantages:

- Easy to use.
- Decorative finish.

Packaging	Content	Code	EAN13 barcode No.	Units/box
Box	1,5kg	10043879	8411729882457	10



## Bricofix Rapid Cement

Quick-setting cement. Both indoor and outdoor use.

### Applications:

- Rapid assembly of panelling.
- Repair of fissures and cracks.
- Joints and placing of pipes.
- Works at sea. Anti-humidity barriers and waterproof plastering.
- Anchors with high resistances: framing and attachments subjected to immediate force. Perimeter edges and filling of cracks
- Blockage of water inlets and capture of running water. Provisional and/or emergency work.
- Ornamental moulds and repair of concrete flooring.

### Advantages:

- Rapid setting.
- High initial resistance.
- Impermeable

Packaging	Content	Code	EAN13 barcode No.	Units/box
Box	1,5kg	10043876	8411729881955	10



## Bricofix White Cement

White Cement for bonding and filling. Both indoor and outdoor use.

### Applications:

- Filling of cracks. Repair of damages, joints and holes.
- Grouting of sanitary fittings, anchors and plumbing in general.

### Advantages:

- Interior and exterior use.
- Lasting, resistant finish

Packaging	Content	Code	EAN13 barcode No.	Units/box
Box	1,5kg	10043874	8411729881382	10



## Bricofix Barbecues and Chimneys

Refractory mortar for barbecues and chimneys. Interior and exterior use.

### Applications:

- Assembly and anchoring of bricks and refractory slabs, solid and hollow concrete blocks, terracotta, subjected to high temperatures (barbecues, chimneys, firewood ovens and stoves for domestic use).

### Advantages:

- Suitable for interior and exterior use.
- Resists up to 1,000°C.
- Resistant to aggressive liquids and cycles of freezing/unfreezing.
- Rapid hardening.



## Bricofix Grey Cement

White Cement for bonding and filling. Both indoor and outdoor use.

### Applications:

- Filling of cracks. Repair of damages, joints and holes.
- Grouting of sanitary fittings, anchors and plumbing in general.

### Advantages:

- Interior and exterior use.
- Lasting, resistant finish.



## Bricofix Grey Mortar

Construction of walls and partitions. Interior and exterior use.

### Applications:

- Assembly of bricks, blocks, inlaid stones, etc.
- Joins and small embedments.
- Excellent adherence to most construction materials.

### Advantages:

- High resistance to compression, flexion and traction.
- Interior and Exterior.

Packaging	Content	Code	EAN13 barcode No.	Units/box
Box	1,5kg	10043162	8411729313364	10

Packaging	Content	Code	EAN13 barcode No.	Units/box
Box	1,5kg	10043875	8411729881535	10

Packaging	Content	Code	EAN13 barcode No.	Units/box
Box	1,5kg	10043878	8411729882297	10

# ART OF THE COLOR

Spray Paint



## Acrylic Paint General Use

Quick drying acrylic paint for repair, decoration and different utilities. It provides a coating of low wear, resistant to scratches, mechanical and environmental effects. The pigments found in the paint are resistant to UV rays and ensure the intense color that will retain its brightness over time.

### Applications:

- Decorative spray to treat surfaces of wood, metal, aluminum, glass, stone and various types of plastic
- Indoor and outdoor.

### Advantages:

- Quick-drying (Tack free: After approximately 10 minutes)
- Brilliant or mate effect
- Wide range of colours
- UV resistant
- The coating prevents the appearance of rust.
- Excellent coverage
- Resistant to gasoline and chemical influences

Packaging	Content	Use	Colour	Code	EAN13 barcode No.	Units/box
Aerosol	400 ml	General	RAL 1021 Colza Yellow	10040456	8411729110567	6
			RAL 1023 Traffic Yellow	10040457	8411729110642	6
			RAL 2004 Pure Orange	10040499	8411729127732	6
			RAL 3000 Flame Red	10040459	8411729110727	6
			RAL 3003 Ruby Red	10040455	8411729110802	6
			RAL 3015 Light Pink	10040460	8411729110987	6
			RAL 3020 Traffic Red	10040445	8411729111069	6
			RAL 4003 Heather Violet	10040446	8411729111144	6
			RAL 5003 Sapphire Blue	10040447	8411729111304	6
			RAL 5010 Gentian Blue	10040448	8411729111489	6
			RAL 5015 Sky Blue	10040449	8411729111557	6
			RAL 5017 Traffic Blue	10040450	8411729111717	6
			RAL 6005 Moss Green	10040454	8411729112059	6
			RAL 6029 Mint Green	10040461	8411729112134	6
			RAL 7001 Silver Grey	10040462	8411729112219	6
			RAL 7011 Iron Grey	10040463	8411729112394	6
			RAL 7016 Anthracite Grey	10040464	8411729112479	6
			RAL 7035 Light Grey	10040466	8411729112547	6
			RAL 8002 Signal Brown / Hazel	10040467	8411729112707	6
			RAL 8004 Copper Brown	10040468	8411729112882	6
			RAL 8011 Nut Brown	10040469	8411729113049	6
			RAL 8017 Chocolate	10040470	8411729113124	6
			RAL 9005 Jet Black	10040471	8411729113209	6
			RAL 9005 Jet Black matt	10040472	8411729113384	6
Ral 9005 Jet Black	10040946	8411729128319	6			
RAL 9006 Aluminium White	10040473	8411729113469	6			
RAL 9010 Pure White	10040474	8411729113537	6			
RAL 9010 Pure White matt	10040475	8411729113872	6			
Ral 9010 Pure White	10040947	8411729128494	6			
Ral 8014 Sepia Brown	10040940	8411729207274	6			
Ral 7021 Black Grey	10040941	8411729207687	6			
Ral 6009 Fir Green	10040942	8411729207762	6			
Ral 9007 Aluminium Grey	10040943	8411729207847	6			
Ral 7042 Traffic Grey A	10040945	8411729207922	6			
Transparent	10040476	8411729113957	6			

Rapid Drying.

Resistant to UV rays.

Prevents the appearance of rust.





### White Electrodomestic

High quality lacquer to embellish and repair pottery and enameled surfaces.

**Applications:**

- For quick and easy repair of irritating scratches or similar small damages on white enamel surfaces such as bath-tubs, sinks, toilet bowls, instantaneous water heaters, refrigerators etc.

**Advantages:**

- Fast drying (Tack free : After 10 to 20 minutes)
- Good filling property
- Resistant to cleaners
- Lasting gloss
- Good surface hardness
- Wear resistant and scratch free
- Good adhesion

### Matt - Shiny Zinc

High quality zinc spray to treat galvanized, treated and untreated steel. Excellent rust-protection for all iron metals (car bodies, gates, machines etc.). Suitable for protection of welding seams and metals which are exposed to corrosion.

**Applications:**

- To repair and adapt color of aluminium or zinced surfaces which have been damaged by welding, sanding, drilling, transportation, etc.

**Advantages:**

- Fast drying (Tack free : After 20 to 30 minutes)
- Good filling property
- Cathodic corrosion protection
- Resistant to petrol, chemicals and weather influences
- Spot-weldable
- Excellent adhesion

### Gold - Silver Chrome - Effect

High quality decorative Spray Paint to use on treated and untreated surfaces like wood, metal, aluminium, glass, stone and various kind of plastics. Creates a look of shining gold, silver and chrome.

**Applications:**

- Decorative Spray Paint to use for all smooth surfaces like metal, wood, glass and many coatable plastics

**Advantages:**

- Very good coverage
- Excellent adhesion
- Resistant to water and common household cleansers
- Effect of gloss can change by intense rubbing or wiping.
- Quick-drying (Tack free: after approximately 10 minutes)
- Good flow, smooth surface
- Very high gloss

### Heat Resistant

Special lacquer of silicone resin basis resistant to high temperatures.

**Applications:**

- Special lacquer to renovate, repair objects exposed to high heat, such as barbecues, stoves, stovepipes, lampshades etc.

**Advantages:**

- High coverage
- Excellent adhesion
- Resistant to weather influences
- Good flow
- Fast drying
- Heat resistant up to 690°C

### Universal - Metal - Plastic Primer

High quality, fast drying primer to treated and untreated surfaces of wood, metal, aluminium, glass, stone and various types of plastic.

**Applications:**

- Suitable primer as pretreatment for re-spraying with all lacquer- acrylic on any wood, metal or plastic surface.

**Advantages:**

- Fast drying (Tack free: after approx. 10-20 minutes)
- Fast drying
- Excellent coverage and filling property
- Corrosion preventive
- Easy to sand
- Re-sprayable with all lacquer systems

### Marker Paint

Professional marking for building construction and civil engineering, construction sites and road construction. Can also be used in tunnel and mine. Guaranteed marking without painting hands or fingers.

**Applications:**

- Marker spray with 360° applicator that allows for better functionality and improved security

**Advantages:**

- Innovative safety cap (prevents unintentional spraying, easy-touch release)
- Marking visible up to 6 months
- High yield - up to 220 m
- Outstanding adhesion also to wet surfaces
- Clean, drip-free marking
- Self-cleaning system

Packaging	Content	Code	EAN13 barcode No.	Units/box
Aerosol	400 ml	10040477	8411729114459	6

Packaging	Content	Colour	Code	EAN13 barcode No.	Units/box
Aerosol	400 ml	Matt	10040521	8411729135324	6
		Shiny	10040500	8411729134907	6

Packaging	Content	Colour	Code	EAN13 barcode No.	Units/box
Aerosol	400 ml	Chrome	10041072	8411729250492	6
		Gold	10040480	8411729116194	6
		Silver	10041069	8411729250157	6

Packaging	Content	Colour	Code	EAN13 barcode No.	Units/box
Aerosol	400 ml	Silver Grey	10040479	8411729114787	6
		Black	10040478	8411729114602	

Packaging	Content	Colour	Code	EAN13 barcode No.	Units/box
Aerosol	400 ml	Universal Primer (Grey)	10041064	8411729202712	6
		Metal Primer (Red)	10041732	8411729206024	
		Plastic Primer (Transparent)	10041729	8411729202897	

Packaging	Content	Colour	Code	EAN13 barcode No.	Units/box
Aerosol	500 ml	Yellow	10041060	8411729206697	12
		Blue	10041061	8411729206772	
		Red	10041062	8411729206857	
		Green	10041063	8411729207199	

# QUILUBE AEROSOL

Multi-purpose lubricant



Lubricates and protects anything that slides, rotates, turns or sizzle.

Lasts up to 4 times longer than traditional lubricants.

Resists fresh and salt water.



## Quilube Aerosol

Multi-purpose synthetic lubricant with PTFE.

**Applications:**

- For lubricating and protecting anything that slides, rotates, turns or sizzles.
- Lubrication for industrial equipment and machinery: bearings, electric motor bearings, rollers, hinges, gears, worm screws, cold machinery, transportation belts, ovens, automobile.

**Advantages:**

- Lasts up to 4 times longer than traditional lubricants.
- Withstands extreme temperatures.
- Repels dust or dirt.
- Resists fresh and salt water.

Packaging	Content	Code	EAN13 barcode No.	Units/box
Aerosol	200 ml	10043862	8411729860339	12
	400 ml	10043863	8411729860582	12

## Quilube Grease

Synthetic grease with PTFE.

**Applications:**

- For lubricating and protecting against corrosion.
- Lubrication for industrial equipment and machinery: bearings, electric motor bearings, rollers, hinges, gears, worm screws, cold machinery, transportation belts, ovens, automobile.

**Advantages:**

- Withstands extreme temperatures.
- Resists cold, hot, fresh salty water.
- It is anti-oxidant and anti-corrosion.

Packaging	Content	Code	EAN13 barcode No.	Units/box
Tube	100 grs	10043861	8411729860257	12
Pail	5 kg	10043891	8411729949464	1





QUILOSA - SELENA IBERIA S.L.U  
[www.quilosa.com](http://www.quilosa.com)  
[info.quilosa@selenas.com](mailto:info.quilosa@selenas.com)  
+34 902 02 18 02

CENTRAL OFFICES  
C/ Marie Curie 19 – Planta 6.1  
28521 Rivas, Madrid – Spain  
Tél.: +34 91 627 84 00

FACTORY  
Polígono Industrial Quer  
C/ Vega del Henares, 3  
19209 Quer – Guadalajara – Spain  
Tél.: +34 672 336 555

